



# TOWN OF WAREHAM

MEMORIAL TOWN HALL  
54 MARION ROAD  
WAREHAM, MA 02571

Permit # 21 - \_\_\_\_\_

Permit Fees:

\$125 Residential Permit

\$200 Commercial Permit

Other Fee \_\_\_\_\_

## 2021 STREET OPENING PERMIT APPLICATION

Date: \_\_\_\_\_

Dig Safe Number: \_\_\_\_\_

Contractor's Name: \_\_\_\_\_

Contractor's Address: \_\_\_\_\_

Phone: \_\_\_\_\_ Cell: \_\_\_\_\_

Email: \_\_\_\_\_

Street Address: \_\_\_\_\_

Property Type: ☐ Residential ☐ Commercial

Owner's Name: \_\_\_\_\_

Proposed Work (explain): \_\_\_\_\_

<input type="checkbox"/> Driveway – repair/repave/alter	<input type="checkbox"/> New Gas Service
<input type="checkbox"/> Drain Connection (see DPW policy)	<input type="checkbox"/> Underground Telecom Work
<input type="checkbox"/> Emergency Gas Repair – Class	<input type="checkbox"/> Emergency Water Leak Repair
<input type="checkbox"/> Underground Electrical Work	<input type="checkbox"/> New/Relay Gas Main
<input type="checkbox"/> New Water Service	<input type="checkbox"/> Other

Start Date: \_\_\_\_\_ Expected Completion Date: \_\_\_\_\_

Name of Insurer: \_\_\_\_\_

Policy Expiration: \_\_\_\_\_

Name of Surety: \_\_\_\_\_

Surety Expiration: \_\_\_\_\_ Bond Amount: \_\_\_\_\_

Signature: \_\_\_\_\_

Are you? Owner: \_\_\_\_\_ Contractor: \_\_\_\_\_

Draw a sketch or furnish a detailed drawing showing the proposed work. Show the location and extent of the proposed work. Indicate the relationship to existing light poles, hydrants, trees, house numbers, traffic signs, etc.: show the relationship to the nearest intersection if within 50 ft. Show north arrow.

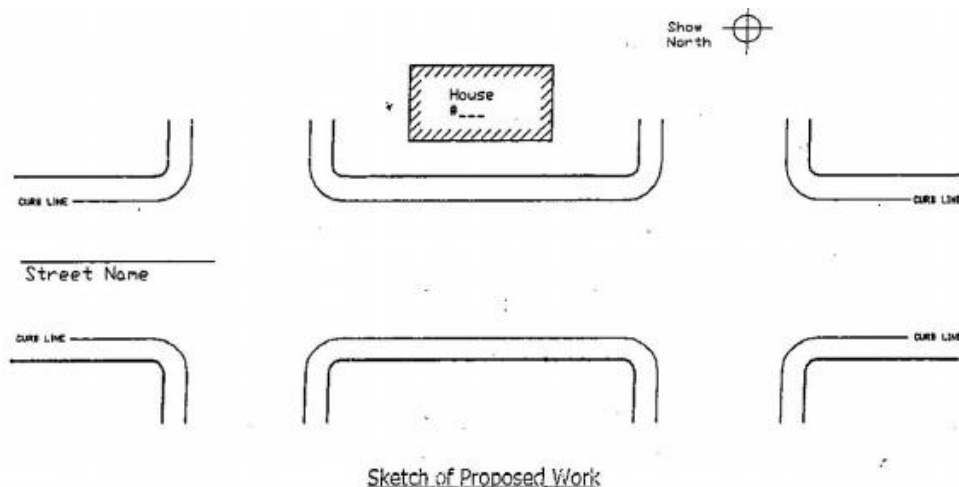

## **GENERAL CONDITIONS:**

### **Public Safety:**

- No trenches shall be left open overnight
- Sidewalks and roadways shall be kept passable at all times
- No work is to be performed during snow emergencies and existing trenches should be secured for plowing 24 hours in advance of any snow prediction
- Uniformed traffic officers shall be furnished as required
- Dig-safe shall be properly notified before work proceeds
- Properly lite barricades shall be used while work is being performed in the street

### **Protection of Property:**

- No tree roots or limbs shall be removed without further approval from the DPW Director/Tree Warden
- Property markers such as bounds or iron pipes shall not be disturbed
- No material or equipment is to be left on public property or within the right-of-way unless authorized

### **Trench Restoration:**

- All work shall conform to the standards set forth in the Town of Wareham's Right of Way Permit Manual
- All street cuts shall be saw cut in straight lines
- Any bituminous curbing distributed is to be cut out of 5' on both sides of the disturbance and replaced with new bituminous curbing by machine and connected to existing curbing. New berm shall be installed of the same style as berm installed adjacent to distributed area.
- No bituminous paving will be permitted during actual or anticipated extreme cold and/or wet conditions
- Any sidewalk disturbed by construction operations shall be restored over its entire width
- All driveway aprons disturbed by longitudinal trenches shall be removed and replaced from the gutter line to the further limit of the excavation
- Temporary pavement shall be replaced daily and shall be brought flush with adjacent existing pavement
- Trenches shall be permanently restored by cutting or grinding a straight clean edge 1' outside the limit of disturbance; grinding or removing the temporary pavement, scarring or other damage that occurred during construction; and overlaying with emulsion and sand at the joints
- Any roadway markings or street signs damaged during construction shall be restored

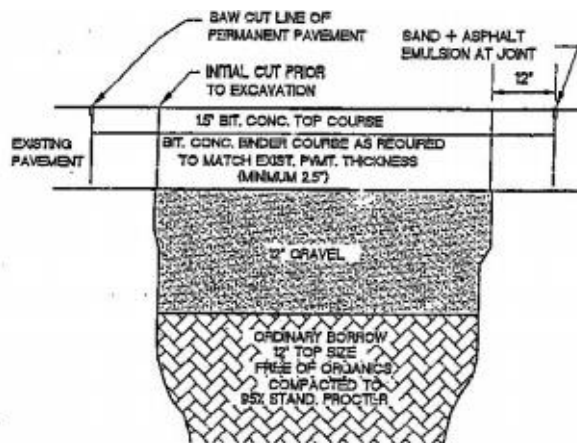

\*\*\* For Office Use Only \*\*\*

### **Special Conditions:**

Infrared Patch by: \_\_\_\_\_ Notify MMD before work proceeds. Inspection by MMD required before backfill

Grind and Inlay Patch by: \_\_\_\_\_ Other \_\_\_\_\_

Incomplete

Photo on file: Yes      Denied (see comments below)

Waive Insurance      Approved for Issue      \_\_\_\_\_  
Director      Date

Waive Bond

PERMIT EXPIRES 20 DAYS AFTER APPROVAL UNLESS NOTED BELOW

Permit Expires: \_\_\_\_\_  
Municipal Maintenance Director      Date

Comments/Special Conditions: \_\_\_\_\_