

NOTES:

1. CONTRACTOR SHALL PROVIDE AND MAINTAIN STAKED SILT FENCE EROSION CONTROL BARRIERS WHERE SHOWN ON THE PLAN. SEE DETAIL ON SHEET 8. REFER TO THE COMPLETE SET OF EROSION CONTROL NOTES ON SHEET 2. EROSION CONTROL MEASURES SHALL BE MAINTAINED UNTIL ALL VEGETATION IS ESTABLISHED.
2. ALL DEBRIS FROM DEMOLITION INCLUDING ANY PAVEMENT & CURBING REMOVAL, UTILITIES REMOVAL, STONE REMOVAL, FENCE REMOVAL, TREE CLEARING, STUMPING, GRUBBING, ETC. SHALL BE REMOVED FROM THE SITE AND NOT STOCKPILED UNLESS OTHERWISE NOTED.
3. CONTRACTOR SHALL CONFIRM THE EXACT LOCATIONS AND ELEVATIONS OF ALL EXISTING WATER LINES, SEWER LINES, ELECTRIC CONDUITS AND GAS LINES PRIOR TO CONSTRUCTION. ALL EXISTING UTILITY SERVICES SHALL BE REMOVED UNLESS OTHERWISE NOTED, COORDINATE WITH THE APPROPRIATE UTILITY COMPANY.
4. CONTRACTOR SHALL CONFIRM TYPE, SIZE AND ELEVATION OF EXISTING SEWER SERVICE PRIOR TO CONSTRUCTION. CONFIRM WITH WAREHAM SEWER DEPARTMENT AND ENGINEER.
5. REFER TO THE COMPLETE SET OF DEMOLITION NOTES ON SHEET 2.
6. ANY EXCAVATION/REMOVAL OF EXISTING FEATURES BELOW ADJACENT GRADE SHALL BE FILLED WITH STRUCTURAL FILL AND COMPACTED.

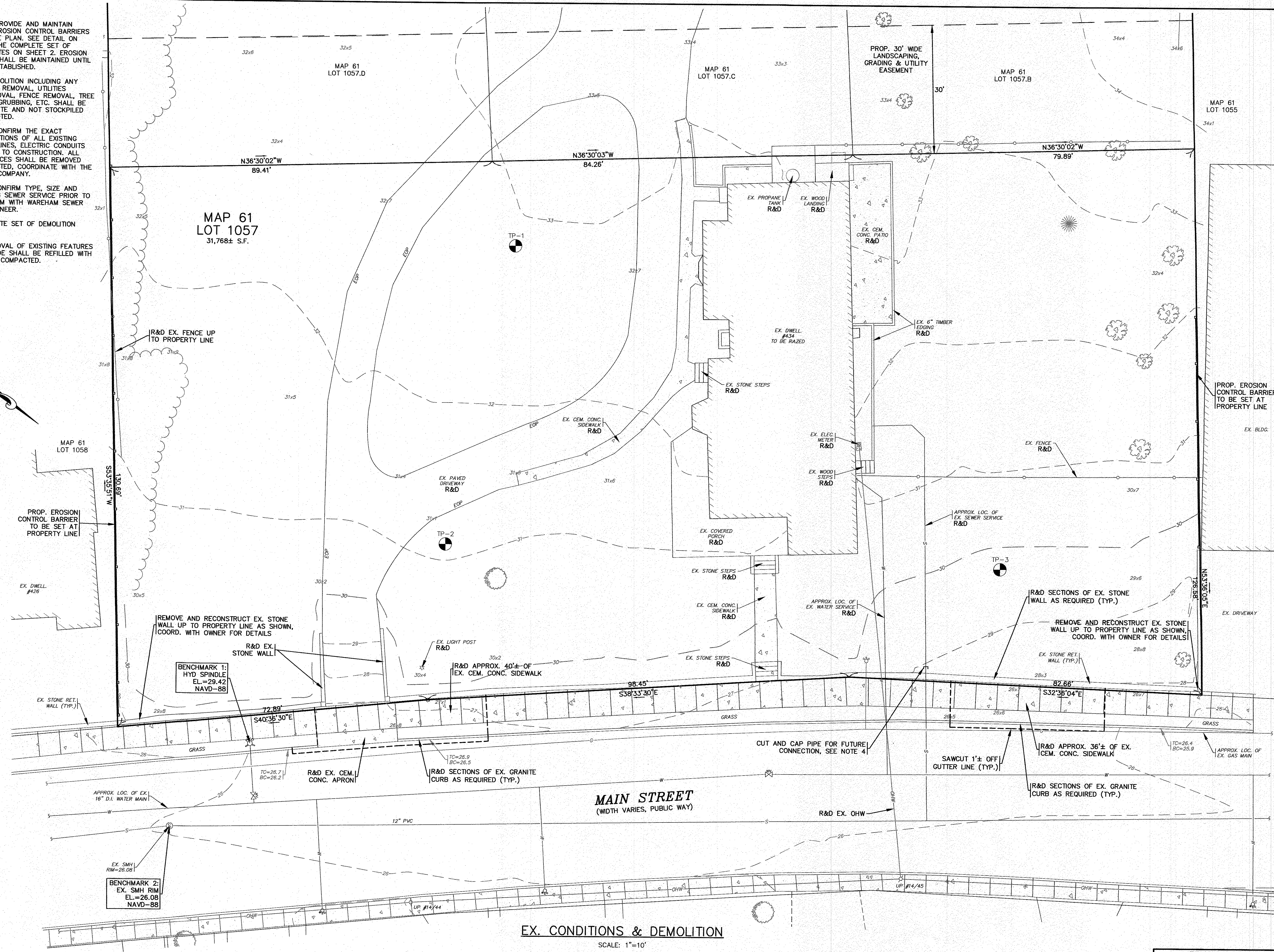
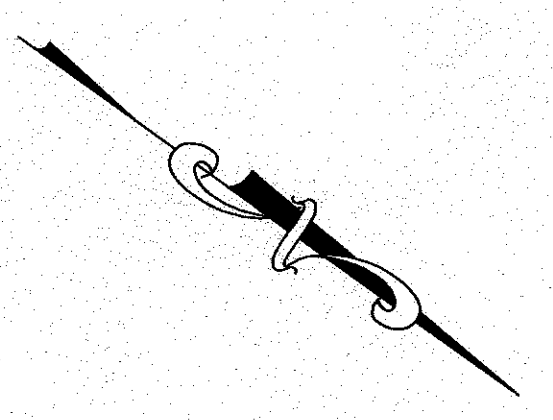

EX. CONDITIONS & DEMOLITION

SCALE: 1"=10'
0 10 20 40

DATE: SEPT. 8, 2022		DRAWN BY: JMP		CHECKED BY: WFM		JOB NO.: 21-9751		SCALE: 1" = 10'	
APPROVED BY:		APPROVED BY:		APPROVED BY:		APPROVED BY:		APPROVED BY:	
G.A.F. ENGINEERING, INC.		G.A.F. ENGINEERING, INC.		G.A.F. ENGINEERING, INC.		G.A.F. ENGINEERING, INC.		G.A.F. ENGINEERING, INC.	
PROFESSIONAL ENGINEERS & LAND SURVEYORS		PROFESSIONAL ENGINEERS & LAND SURVEYORS		PROFESSIONAL ENGINEERS & LAND SURVEYORS		PROFESSIONAL ENGINEERS & LAND SURVEYORS		PROFESSIONAL ENGINEERS & LAND SURVEYORS	
266 MAIN STREET - WAREHAM, MA 02571		266 MAIN STREET - WAREHAM, MA 02571		266 MAIN STREET - WAREHAM, MA 02571		266 MAIN STREET - WAREHAM, MA 02571		266 MAIN STREET - WAREHAM, MA 02571	
TEL: (508) 295-6600 FAX: (508) 295-6634		TEL: (508) 295-6600 FAX: (508) 295-6634		TEL: (508) 295-6600 FAX: (508) 295-6634		TEL: (508) 295-6600 FAX: (508) 295-6634		TEL: (508) 295-6600 FAX: (508) 295-6634	
E-MAIL: info@gafeng.com		E-MAIL: info@gafeng.com		E-MAIL: info@gafeng.com		E-MAIL: info@gafeng.com		E-MAIL: info@gafeng.com	
COPYRIGHT © 2022 G.A.F. ENGINEERING, INC. NO PART OF THIS DOCUMENT MAY BE REPRODUCED, STORED, OR TRANSMITTED IN ANY MANNER WITHOUT THE WRITTEN CONSENT OF G.A.F. ENGINEERING, INC. WITH THE EXCEPTION OF ANY REGULATORY AGENCIES UNDER ITS JURISDICTION. ANY REPRODUCTIONS MADE TO THIS DOCUMENT WITHOUT THE EXPRESS WRITTEN CONSENT OF G.A.F. ENGINEERING, INC. SHALL BE DEEMED UNLAWFUL.		COPYRIGHT © 2022 G.A.F. ENGINEERING, INC. NO PART OF THIS DOCUMENT MAY BE REPRODUCED, STORED, OR TRANSMITTED IN ANY MANNER WITHOUT THE WRITTEN CONSENT OF G.A.F. ENGINEERING, INC. WITH THE EXCEPTION OF ANY REGULATORY AGENCIES UNDER ITS JURISDICTION. ANY REPRODUCTIONS MADE TO THIS DOCUMENT WITHOUT THE EXPRESS WRITTEN CONSENT OF G.A.F. ENGINEERING, INC. SHALL BE DEEMED UNLAWFUL.		COPYRIGHT © 2022 G.A.F. ENGINEERING, INC. NO PART OF THIS DOCUMENT MAY BE REPRODUCED, STORED, OR TRANSMITTED IN ANY MANNER WITHOUT THE WRITTEN CONSENT OF G.A.F. ENGINEERING, INC. WITH THE EXCEPTION OF ANY REGULATORY AGENCIES UNDER ITS JURISDICTION. ANY REPRODUCTIONS MADE TO THIS DOCUMENT WITHOUT THE EXPRESS WRITTEN CONSENT OF G.A.F. ENGINEERING, INC. SHALL BE DEEMED UNLAWFUL.		COPYRIGHT © 2022 G.A.F. ENGINEERING, INC. NO PART OF THIS DOCUMENT MAY BE REPRODUCED, STORED, OR TRANSMITTED IN ANY MANNER WITHOUT THE WRITTEN CONSENT OF G.A.F. ENGINEERING, INC. WITH THE EXCEPTION OF ANY REGULATORY AGENCIES UNDER ITS JURISDICTION. ANY REPRODUCTIONS MADE TO THIS DOCUMENT WITHOUT THE EXPRESS WRITTEN CONSENT OF G.A.F. ENGINEERING, INC. SHALL BE DEEMED UNLAWFUL.		COPYRIGHT © 2022 G.A.F. ENGINEERING, INC. NO PART OF THIS DOCUMENT MAY BE REPRODUCED, STORED, OR TRANSMITTED IN ANY MANNER WITHOUT THE WRITTEN CONSENT OF G.A.F. ENGINEERING, INC. WITH THE EXCEPTION OF ANY REGULATORY AGENCIES UNDER ITS JURISDICTION. ANY REPRODUCTIONS MADE TO THIS DOCUMENT WITHOUT THE EXPRESS WRITTEN CONSENT OF G.A.F. ENGINEERING, INC. SHALL BE DEEMED UNLAWFUL.	
SITE DEVELOPMENT PLAN		SITE DEVELOPMENT PLAN		SITE DEVELOPMENT PLAN		SITE DEVELOPMENT PLAN		SITE DEVELOPMENT PLAN	
EX. CONDITIONS & DEMOLITION		EX. CONDITIONS & DEMOLITION		EX. CONDITIONS & DEMOLITION		EX. CONDITIONS & DEMOLITION		EX. CONDITIONS & DEMOLITION	
WAREHAM, MA		WAREHAM, MA		WAREHAM, MA		WAREHAM, MA		WAREHAM, MA	
PREPARED FOR:		PREPARED FOR:		PREPARED FOR:		PREPARED FOR:		PREPARED FOR:	
NAZIH B. ELKALLASSI		NAZIH B. ELKALLASSI		NAZIH B. ELKALLASSI		NAZIH B. ELKALLASSI		NAZIH B. ELKALLASSI	
434 MAIN STREET		434 MAIN STREET		434 MAIN STREET		434 MAIN STREET		434 MAIN STREET	
20 TOWER TERRACE		20 TOWER TERRACE		20 TOWER TERRACE		20 TOWER TERRACE		20 TOWER TERRACE	
JOB NO.: 21-9751		JOB NO.: 21-9751		JOB NO.: 21-9751		JOB NO.: 21-9751		JOB NO.: 21-9751	
DWG. 3 OF 9		DWG. 3 OF 9		DWG. 3 OF 9		DWG. 3 OF 9		DWG. 3 OF 9	
PERMIT SET (NOT FOR CONSTRUCTION)		PERMIT SET (NOT FOR CONSTRUCTION)		PERMIT SET (NOT FOR CONSTRUCTION)		PERMIT SET (NOT FOR CONSTRUCTION)		PERMIT SET (NOT FOR CONSTRUCTION)	

NOTES:

- REFER TO ARCHITECTURAL PLANS PREPARED BY OTHERS FOR ALL PROPOSED TOWNHOUSE DIMENSIONS, CONSTRUCTION NOTES AND DETAILS. CONTRACTOR SHALL CONFIRM TOP OF FOUNDATION AND GARAGE SLAB ELEVATIONS WITH OWNER PRIOR TO CONSTRUCTION.
- ALL SEWER WORK SHALL BE DONE IN ACCORDANCE WITH THE TOWN OF WAREHAM SEWER COMMISSIONERS RULES AND REGULATIONS.
- CONTRACTOR SHALL CONFIRM TYPE, SIZE AND ELEVATION OF EXISTING SEWER SERVICE PRIOR TO CONSTRUCTION. CONFIRM WITH WAREHAM SEWER DEPARTMENT AND ENGINEER.
- CONTRACTOR SHALL COORDINATE WITH THE WAREHAM WATER DEPARTMENT WHERE SEWER IS LESS THAN 10 FEET TO WATER SERVICE OR WHERE SEWER MUST CROSS WATER SERVICE.
- FINAL BUILDING SEWER INVERTS SHALL BE DETERMINED AT TIME OF CONSTRUCTION. CONTRACTOR SHALL COORDINATE WITH PLUMBER.
- CONTRACTOR SHALL COORDINATE WITH THE LOCAL UTILITY COMPANY AND ELECTRICIAN FOR FINAL LOCATION, SIZE, CONFIGURATION AND ALL CONSTRUCTION DETAILS OF THE PROPOSED TRANSFORMER, OVERHEAD WIRES AND UTILITY POLE WITH SERVICE DROP.
- THE FINAL LOCATIONS, DEPTH'S AND CONSTRUCTION DETAILS OF THE PROPOSED UNDERGROUND ELECTRIC SERVICE AND ELECTRIC METERS SHALL BE DETERMINED BY THE LOCAL UTILITY COMPANY. CONTRACTOR SHALL COORDINATE WITH LOCAL UTILITY COMPANY AND ELECTRICIAN PRIOR TO CONSTRUCTION.
- CONTRACTOR SHALL RECONSTRUCT EXISTING SIDEWALK UPON COMPLETION OF WORK. COORDINATE WITH THE WAREHAM MUNICIPAL MAINTENANCE DEPARTMENT.
- CONTRACTOR SHALL COORDINATE WITH OWNER FOR ALL DETAILS ON THE PROPOSED RETAINING WALL. WALL DESIGN SHALL MEET ALL STATE AND LOCAL BUILDING CODES, FINAL DESIGN BY OTHERS.
- THE FINAL LOCATIONS, DEPTH'S AND CONSTRUCTION DETAILS OF THE PROPOSED GAS SERVICE AND GAS METERS SHALL BE DETERMINED BY THE LOCAL GAS COMPANY. CONTRACTOR SHALL COORDINATE WITH LOCAL GAS COMPANY PRIOR TO CONSTRUCTION.
- CONFIRM FINAL SNOW REMOVAL AREA WITH OWNER.
- LOAM AND SEED ALL DISTURBED AREAS.

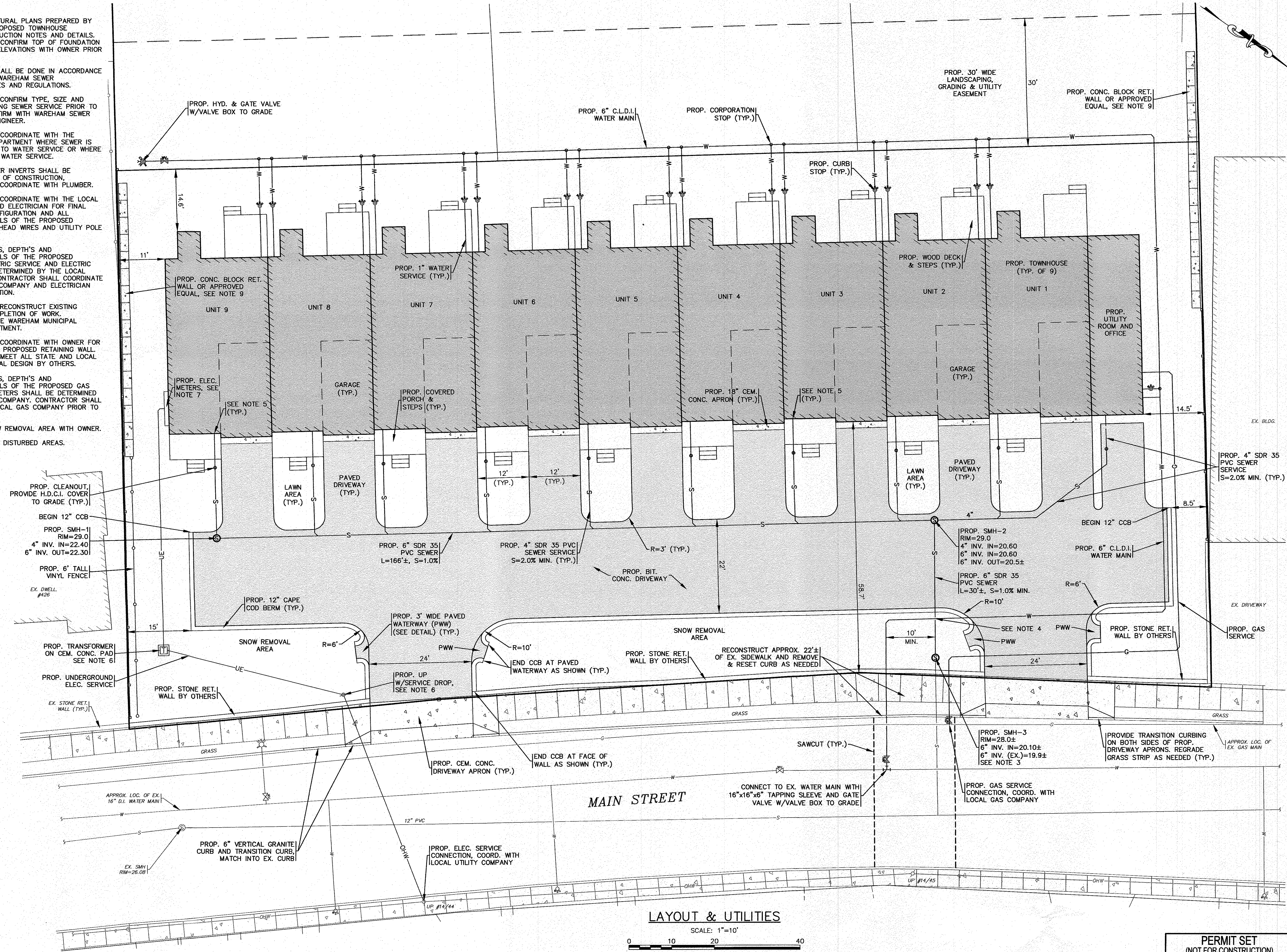

LAYOUT & UTILITIES
SCALE: 1"=10'

DATE: SEPT. 8, 2022	APPROVED BY:	
DRAWN BY: JMP	DATE:	
CHECKED BY: WFM	REV:	
JOB NO.: 21-9751	BY:	
SCALE: 1" = 10'	DESCRIPTION:	
G.A.F. ENGINEERING, INC. PROFESSIONAL ENGINEERS & LAND SURVEYORS 286 MAIN STREET - WAREHAM, MA 02571 TEL: (508) 295-6600 FAX: (508) 295-6634 E-MAIL: info@gafengrnc.com		
SITE DEVELOPMENT PLAN LAYOUT & UTILITIES 434 MAIN STREET WAREHAM, MA PREPARED FOR: NAZIH B. ELKALLASSI 20 TOWER TERRACE WAREHAM, MA		
JOB NO.: 21-9751 DWG. 4 OF 9		PERMIT SET (NOT FOR CONSTRUCTION)

H:\OF DRAWINGS\2022 DRAWINGS\21-9751 (NAZIH ELKALLASSI)\P21.dwg SITE PLAN 2022.dwg

NOTES:

- REFER TO ARCHITECTURAL PLANS PREPARED BY OTHERS FOR ALL PROPOSED TOWNHOUSE DIMENSIONS, CONSTRUCTION NOTES AND DETAILS. CONTRACTOR SHALL CONFIRM TOP OF FOUNDATION AND GARAGE SLAB ELEVATIONS WITH OWNER PRIOR TO CONSTRUCTION.
- ALL PROPOSED CATCH BASINS SHALL HAVE A TEMPORARY SILT SACK INSTALLED IN THEM AS SOON AS THE STRUCTURE IS SET. CONTRACTOR SHALL EMPTY WHEN NEEDED AND REMOVE & DISPOSE OF THE SILT SACKS AT THE COMPLETION OF CONSTRUCTION.
- ALL PROPOSED DRAIN MANHOLES SHALL HAVE A 4" SUMP AND ALL OUTLET PIPES SHALL BE PROVIDED WITH A NYLOPLAST ENVIROHOOD, SEE DETAIL.
- ALL PROPOSED CATCH BASINS SHALL BE PROVIDED WITH A 22" DIA. BEEHIVE FRAME AND GRATE, SEE DETAIL.
- REFER TO ARCHITECTURAL PLANS BY OTHERS FOR FINAL LOCATIONS, SIZES AND COMPLETE DETAILS ON THE PROPOSED DOWNSPOUTS.
- WATER MAIN/SERVICES SHALL BE INSTALLED A MINIMUM OF 1' BELOW ALL PROPOSED DRAINAGE AND ROOF DRAINAGE PIPES AND 5' MINIMUM BELOW GRADE.
- LOAM AND SEED ALL DISTURBED AREAS.

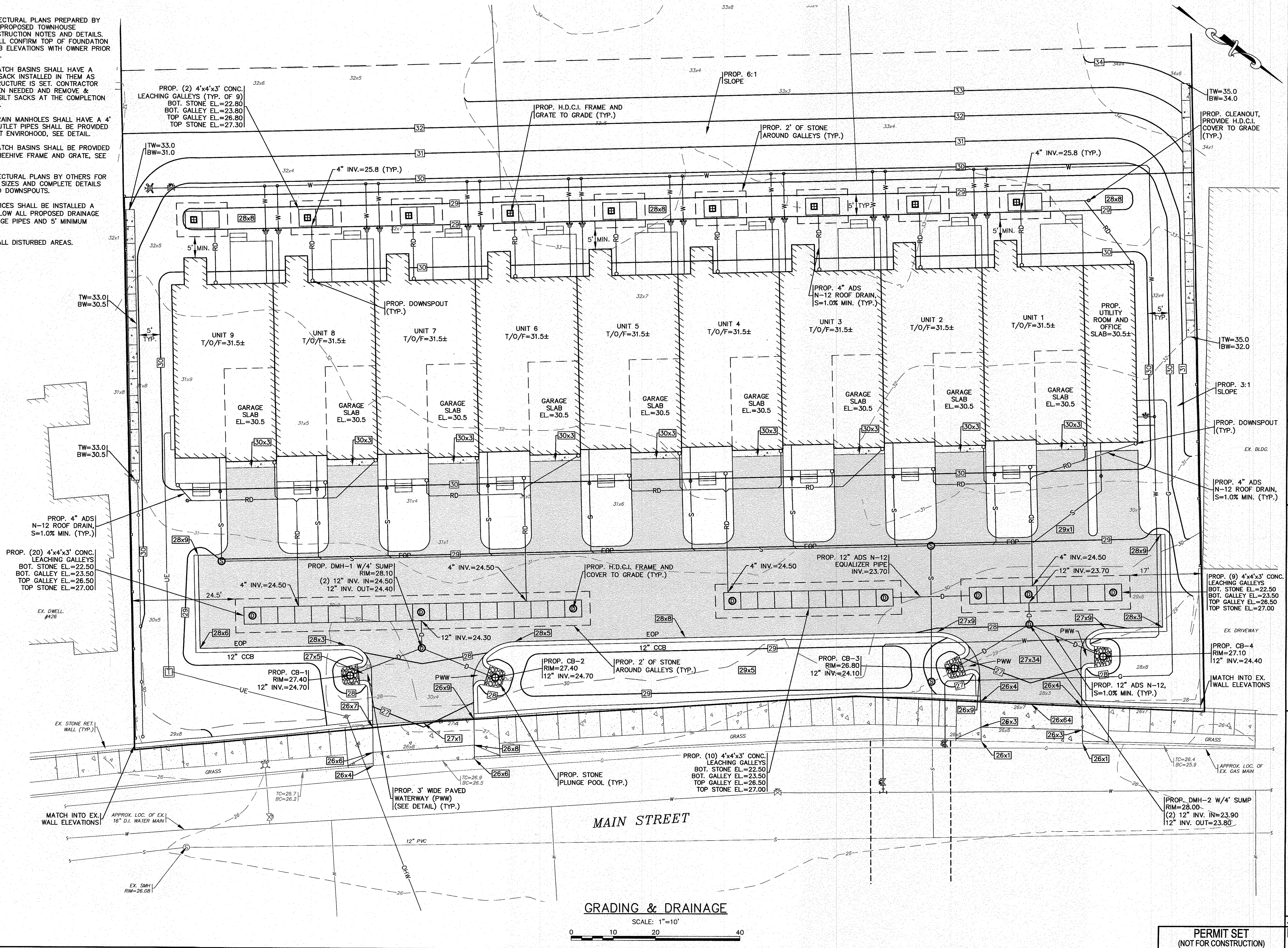

REV.	DATE	BY	APP'D	DESCRIPTION

DATE: SEPT. 8, 2022
 DRAWN BY: JMP
 CHECKED BY: WFM
 JOB NO.: 21-9751
 SCALE: 1" = 10'

APPROVED BY: *[Signature]*
 G.A.F. ENGINEERING, INC.
 PROFESSIONAL ENGINEERS & LAND SURVEYORS
 266 MAIN STREET - WAREHAM, MA 02571
 TEL: (508) 295-6600 FAX: (508) 295-6634
 E-MAIL: info@gafeng.com

APPROVED BY: *[Signature]*
 G.A.F. ENGINEERING, INC.
 PROFESSIONAL ENGINEERS & LAND SURVEYORS
 266 MAIN STREET - WAREHAM, MA 02571
 TEL: (508) 295-6600 FAX: (508) 295-6634
 E-MAIL: info@gafeng.com

PREPARED FOR:
 NAZIH B. ELKALLASSI
 434 MAIN STREET WAREHAM, MA
 20 TOWER TERRACE WAREHAM, MA

**SITE DEVELOPMENT PLAN
 GRADING & DRAINAGE**

PERMIT SET
 (NOT FOR CONSTRUCTION)

DWG. 5 OF 9

H:\DWG\DRAWINGS\2022\DRAWINGS\21-9751\NAZIH ELKALLASSI\0521.dwg (SITE PLAN 2022.dwg)

NOTES:

1. CONTRACTOR SHALL PROVIDE AND MAINTAIN STAKED SILT FENCE EROSION CONTROL BARRIERS WHERE SHOWN ON THE PLAN. SEE DETAIL ON SHEET 8. REFER TO THE COMPLETE SET OF EROSION CONTROL NOTES ON SHEET 2. EROSION CONTROL MEASURES SHALL BE MAINTAINED UNTIL ALL VEGETATION IS ESTABLISHED.
2. ALL PROPOSED CATCH BASINS SHALL HAVE A TEMPORARY SILT SACK INSTALLED IN THEM AS SOON AS THE STRUCTURE IS SET. CONTRACTOR SHALL EMPTY WHEN NEEDED AND REMOVE & DISPOSE OF THE SILT SACKS AT THE COMPLETION OF CONSTRUCTION.
3. THE FINAL LOCATION AND ALL DETAILS OF CONTRACTOR'S STAGING AREA SHALL BE DETERMINED BY THE CONTRACTOR AT TIME OF CONSTRUCTION. CONTRACTOR SHALL COORDINATE WITH OWNER ON LOCATION.
4. THE FINAL LOCATION OF THE TEMPORARY MATERIAL STOCKPILE AREA SHALL BE DETERMINED IN THE FIELD BY THE CONTRACTOR AT TIME OF CONSTRUCTION. CONTRACTOR SHALL COORDINATE WITH OWNER ON LOCATION. THE TEMPORARY MATERIAL STOCKPILE AREA SHALL BE SURROUNDED BY SILT FENCE AT ALL TIMES.
5. CONTRACTOR SHALL SIZE, PROVIDE AND MAINTAIN DEWATERING EQUIPMENT FOR THE CONTROL, COLLECTION AND DISPOSAL OF GROUND WATER WHERE NECESSARY TO COMPLETE THE WORK. FINAL SIZE AND LOCATION FOR DEWATERING EQUIPMENT SHALL BE DETERMINED IN THE FIELD BY THE CONTRACTOR AT TIME OF CONSTRUCTION.
6. CEMENT CONCRETE WASHOUT AREA SHALL BE A SQUARE OF DOUBLE STAKED HAY BALES WITH SILTATION FENCE AND LINED WITH A 40 MIL. POLYETHYLENE BARRIER, SEE DETAIL ON SHEET 8. FINAL WASHOUT LOCATION SHALL BE DETERMINED IN THE FIELD BY THE CONTRACTOR AT THE TIME OF CONSTRUCTION. CONTRACTOR SHALL COORDINATE WITH OWNER ON LOCATION.
7. AT THE COMPLETION OF CONSTRUCTION THE CONTRACTOR SHALL INSPECT ALL DRAINAGE STRUCTURES FOR EVIDENCE OF SEDIMENT OR DEBRIS ACCUMULATION. REMOVE AND DISPOSE OF ANY DEBRIS AND SEDIMENT AS REQUIRED.
8. THE PROPOSED LIMIT OF WORK LINE IS SHOWN OFFSET IN AREAS FOR CLARITY.

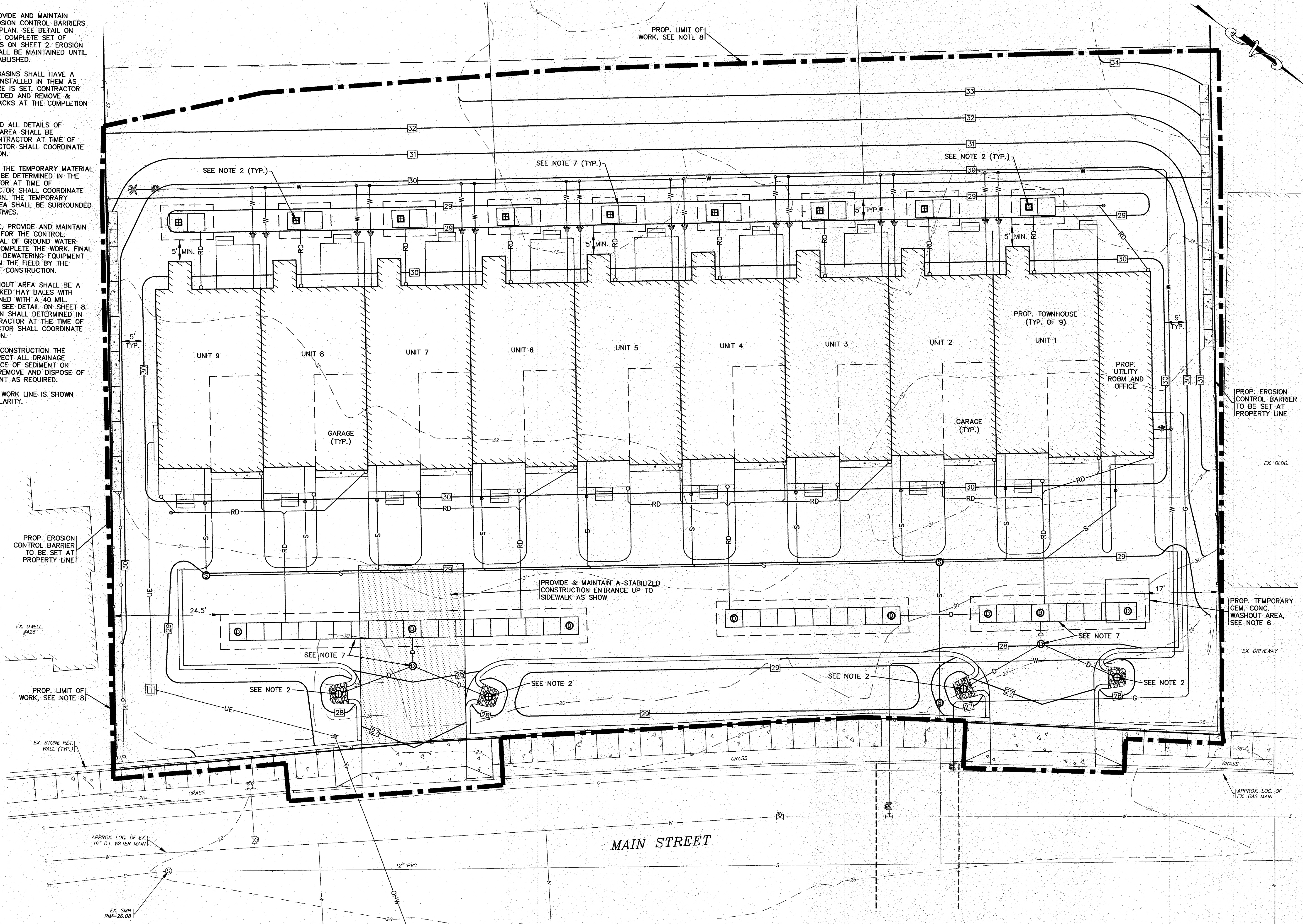

EROSION CONTROL PLAN
SCALE: 1"=10'

DATE: SEPT. 8, 2022	DRAWN BY: J.M.P.	CHECKED BY: W.F.M.	JOB NO.: 21-9751	SCALE: 1" = 10'
APPROVED BY: [Signature]				
G.A.F. ENGINEERING, INC. PROFESSIONAL ENGINEERS & LAND SURVEYORS 266 MAIN STREET - WAREHAM, MA 02571 TEL: (508) 295-6600 FAX: (508) 295-6634 E-MAIL: info@gafenginc.com				
PREPARED FOR: NAZIH B. ELKALLASSI 20 TOWER TERRACE WAREHAM, MA				
SITE DEVELOPMENT PLAN EROSION CONTROL PLAN 434 MAIN STREET WAREHAM, MA				
PERMIT SET (NOT FOR CONSTRUCTION)				
DWG. NO.: 21-9751 6 OF 9				

H:\OFF DRAWINGS\2021 DRAWINGS\21-9751 (NAZIH ELKALLASSI)\9751.dwg (SITE PLAN_2022.dwg)

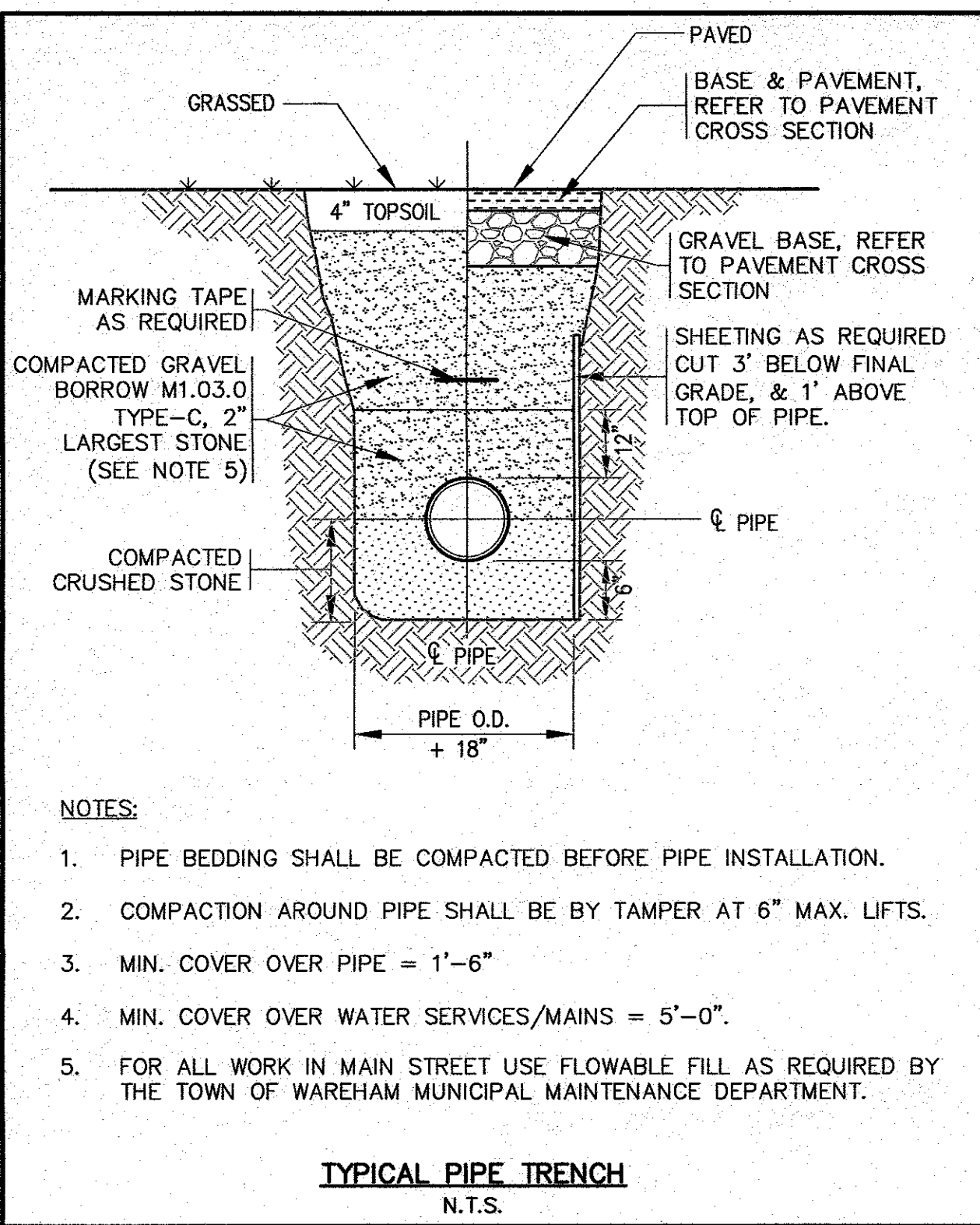

- NOTES:**
- PIPE BEDDING SHALL BE COMPACTED BEFORE PIPE INSTALLATION.
 - COMPACTION AROUND PIPE SHALL BE BY TAMPER AT 6" MAX. LIFTS.
 - MIN. COVER OVER PIPE = 1'-6"
 - MIN. COVER OVER WATER SERVICES/MAINS = 5'-0"
 - FOR ALL WORK IN MAIN STREET USE FLOWABLE FILL AS REQUIRED BY THE TOWN OF WAREHAM MUNICIPAL MAINTENANCE DEPARTMENT.

TYPICAL PIPE TRENCH
N.T.S.

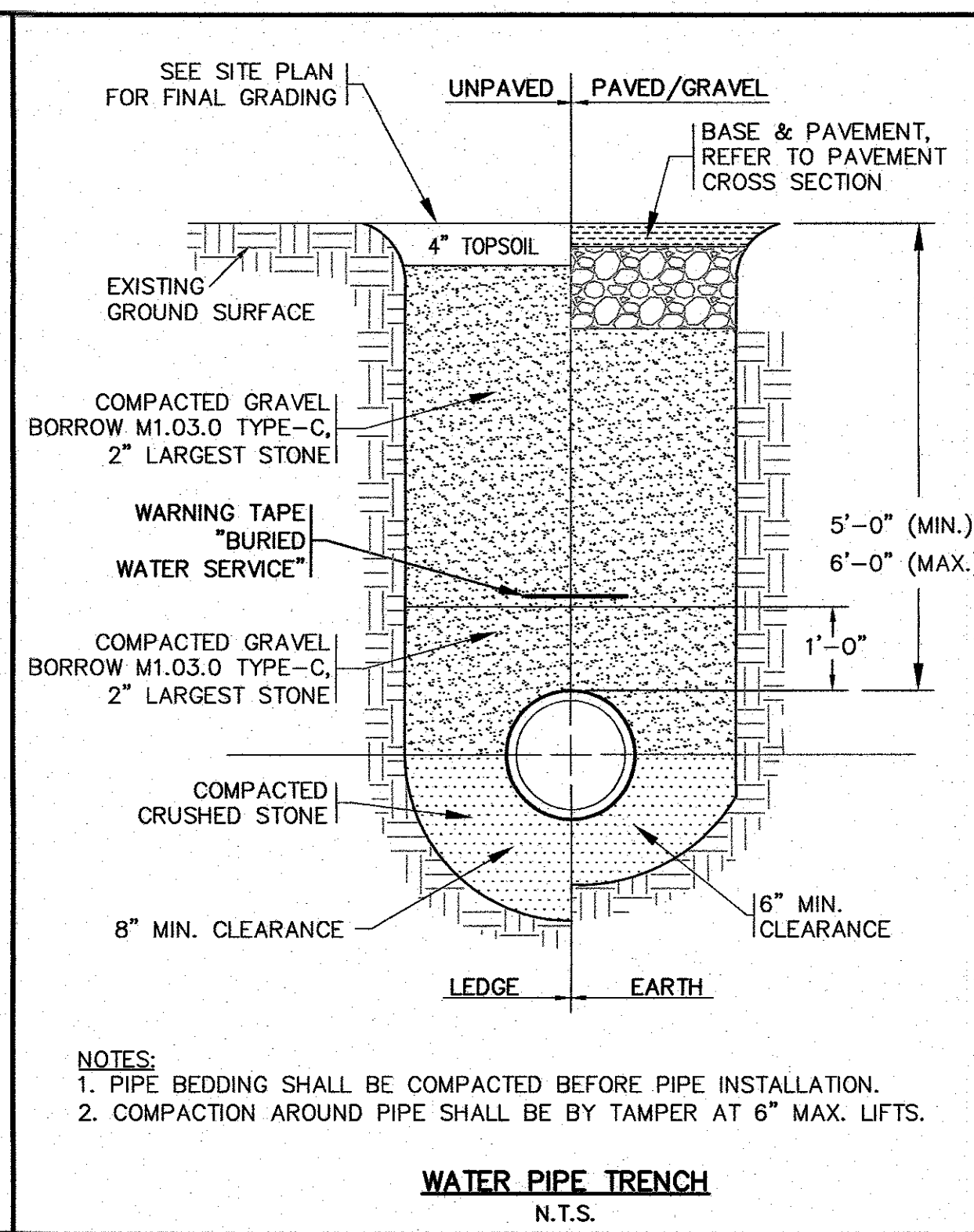

- NOTES:**
- PIPE BEDDING SHALL BE COMPACTED BEFORE PIPE INSTALLATION.
 - COMPACTION AROUND PIPE SHALL BE BY TAMPER AT 6" MAX. LIFTS.

WATER PIPE TRENCH
N.T.S.

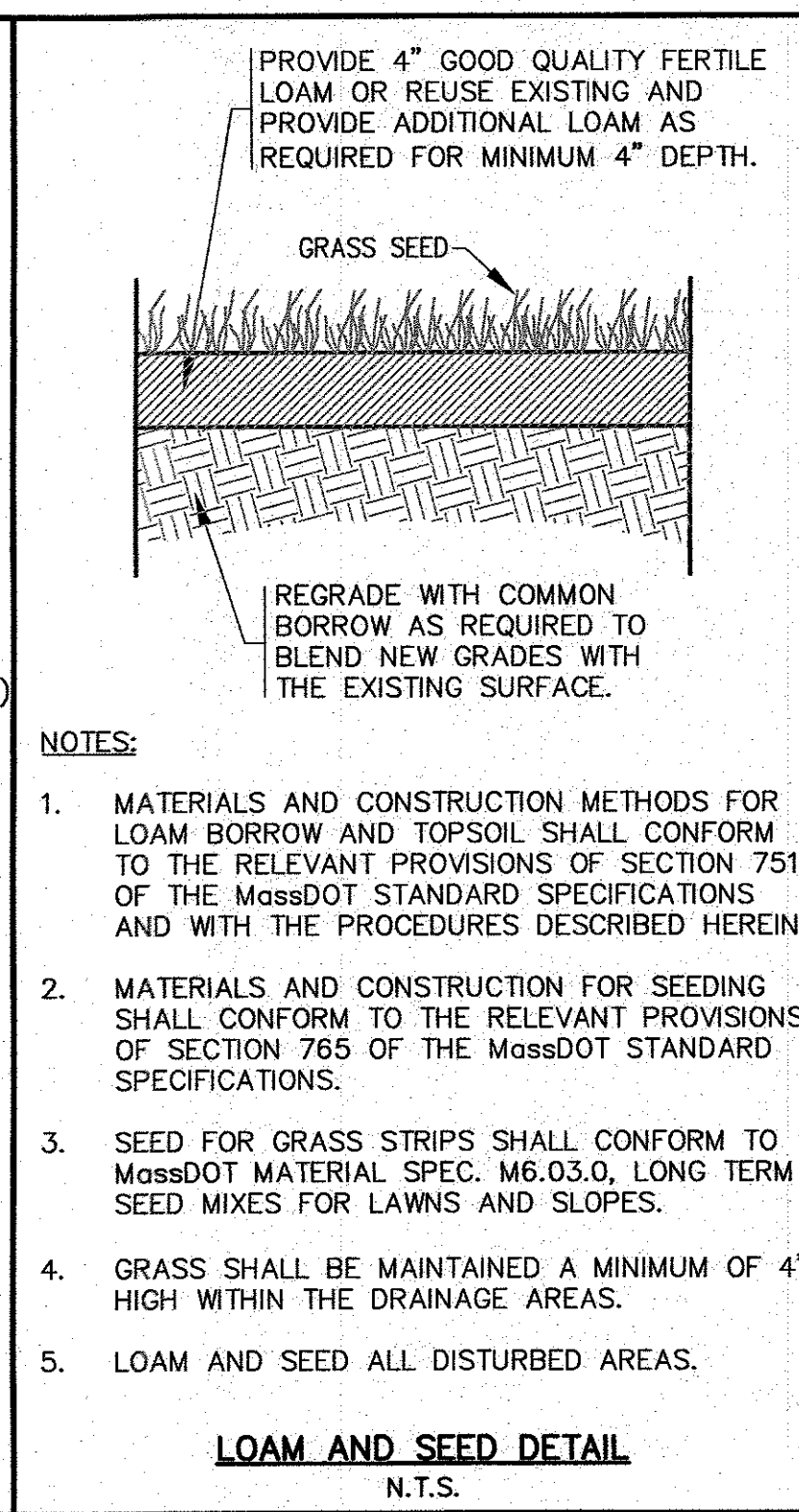

- NOTES:**
- MATERIALS AND CONSTRUCTION METHODS FOR LOAM BORROW AND TOPSOIL SHALL CONFORM TO THE RELEVANT PROVISIONS OF SECTION 751 OF THE MassDOT STANDARD SPECIFICATIONS AND WITH THE PROCEDURES DESCRIBED HEREIN.
 - MATERIALS AND CONSTRUCTION FOR SEEDING SHALL CONFORM TO THE RELEVANT PROVISIONS OF SECTION 765 OF THE MassDOT STANDARD SPECIFICATIONS.
 - SEED FOR GRASS STRIPS SHALL CONFORM TO MassDOT MATERIAL SPEC. M6.03.0, LONG TERM SEED MIXES FOR LAWNS AND SLOPES.
 - GRASS SHALL BE MAINTAINED A MINIMUM OF 4" HIGH WITHIN THE DRAINAGE AREAS.
 - LOAM AND SEED ALL DISTURBED AREAS.

LOAM AND SEED DETAIL
N.T.S.

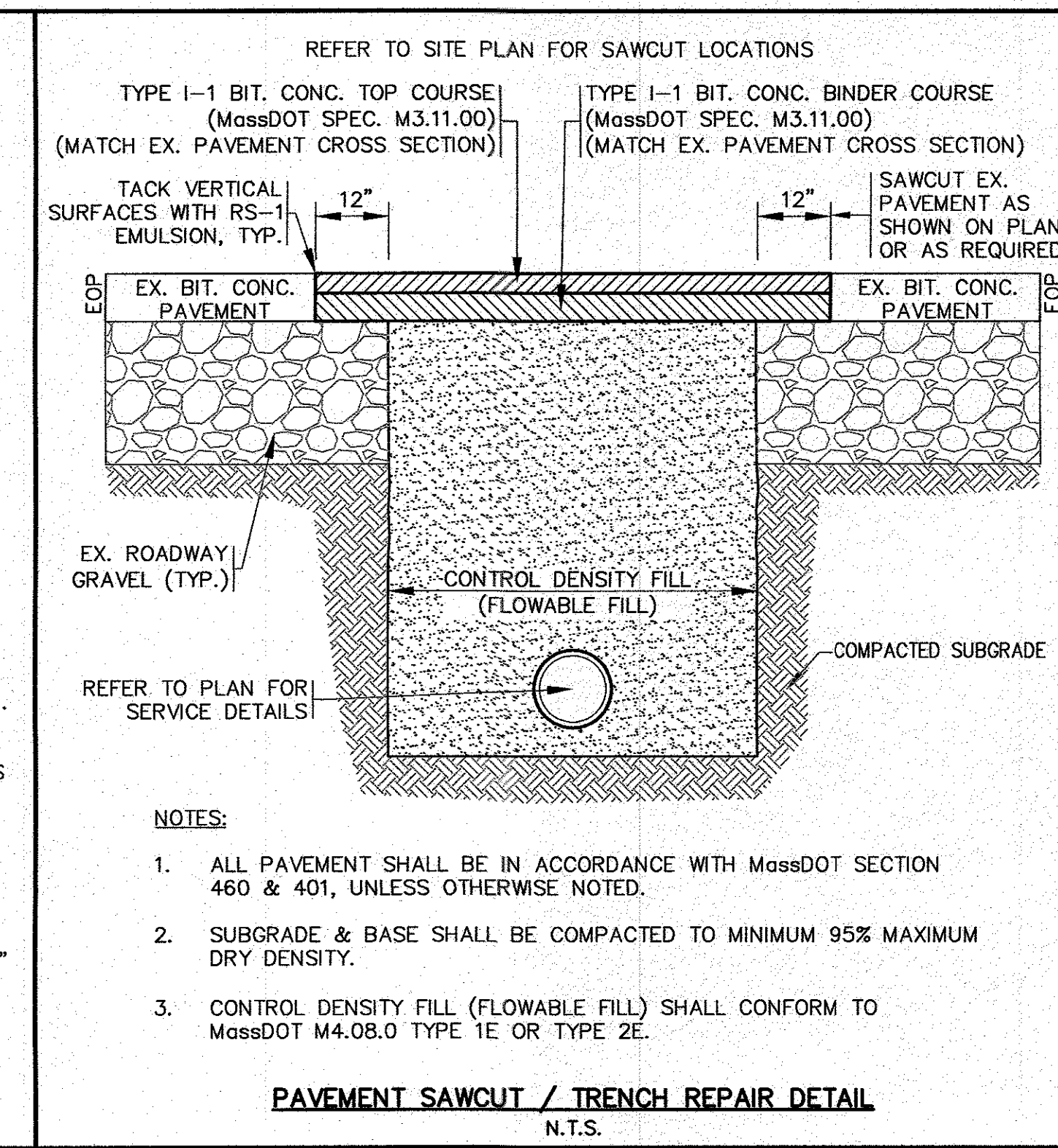

- NOTES:**
- ALL PAVEMENT SHALL BE IN ACCORDANCE WITH MassDOT SECTION 460 & 401, UNLESS OTHERWISE NOTED.
 - SUBGRADE & BASE SHALL BE COMPACTED TO MINIMUM 95% MAXIMUM DRY DENSITY.
 - CONTROL DENSITY FILL (FLOWABLE FILL) SHALL CONFORM TO MassDOT M4.08.0 TYPE 1E OR TYPE 2E.

PAVEMENT SAWCUT / TRENCH REPAIR DETAIL
N.T.S.

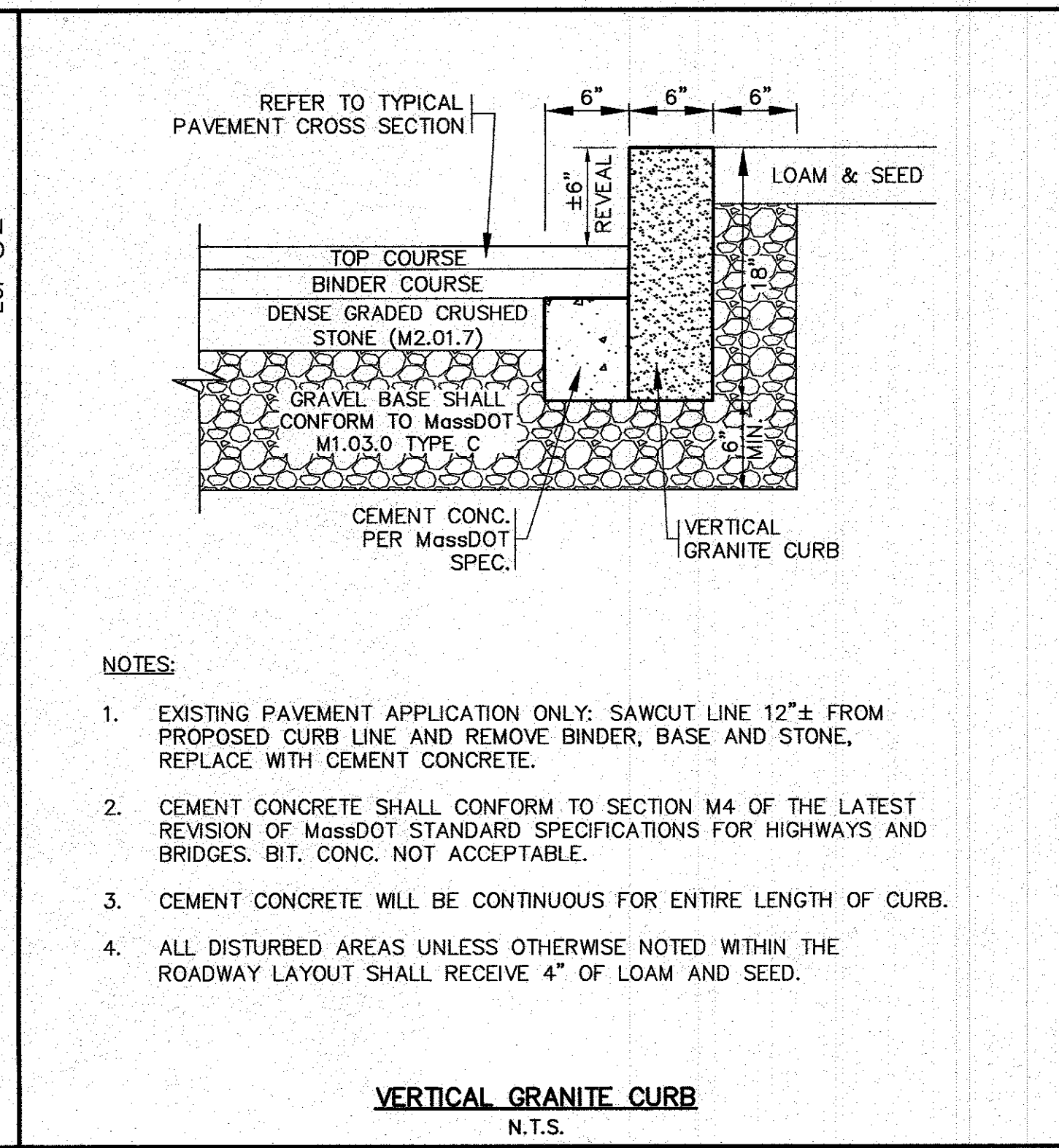

- NOTES:**
- EXISTING PAVEMENT APPLICATION ONLY: SAWCUT LINE 12"± FROM PROPOSED CURB LINE AND REMOVE BINDER, BASE AND STONE, REPLACE WITH CEMENT CONCRETE.
 - CEMENT CONCRETE SHALL CONFORM TO SECTION M4 OF THE LATEST REVISION OF MassDOT STANDARD SPECIFICATIONS FOR HIGHWAYS AND BRIDGES. BIT. CONC. NOT ACCEPTABLE.
 - CEMENT CONCRETE WILL BE CONTINUOUS FOR ENTIRE LENGTH OF CURB.
 - ALL DISTURBED AREAS UNLESS OTHERWISE NOTED WITHIN THE ROADWAY LAYOUT SHALL RECEIVE 4" OF LOAM AND SEED.

VERTICAL GRANITE CURB
N.T.S.

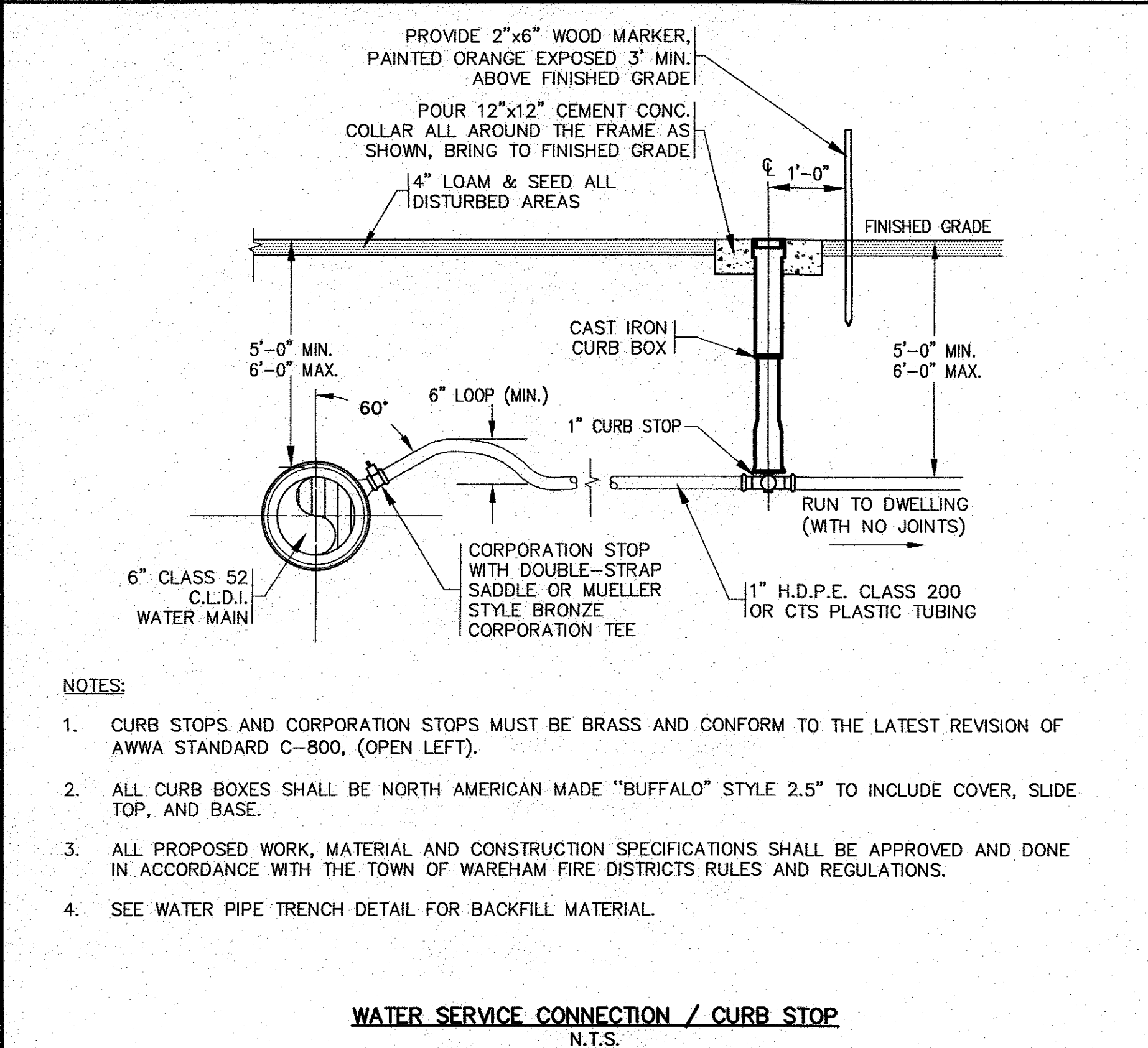

- NOTES:**
- CURB STOPS AND CORPORATION STOPS MUST BE BRASS AND CONFORM TO THE LATEST REVISION OF AWWA STANDARD C-800, (OPEN LEFT).
 - ALL CURB BOXES SHALL BE NORTH AMERICAN MADE "BUFFALO" STYLE 2.5" TO INCLUDE COVER, SLIDE TOP, AND BASE.
 - ALL PROPOSED WORK, MATERIAL AND CONSTRUCTION SPECIFICATIONS SHALL BE APPROVED AND DONE IN ACCORDANCE WITH THE TOWN OF WAREHAM FIRE DISTRICTS RULES AND REGULATIONS.
 - SEE WATER PIPE TRENCH DETAIL FOR BACKFILL MATERIAL.

WATER SERVICE CONNECTION / CURB STOP
N.T.S.

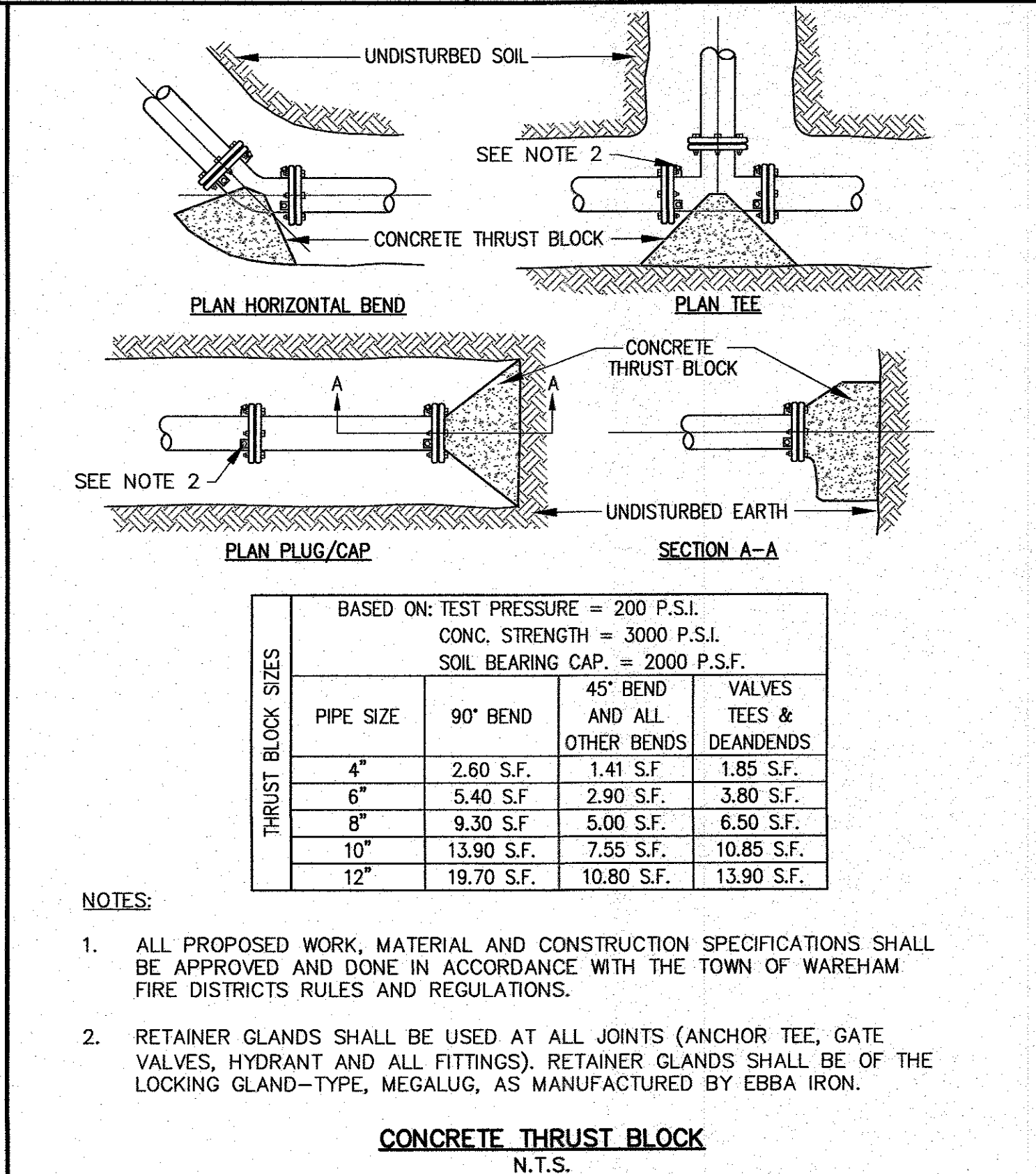

- NOTES:**
- ALL PROPOSED WORK, MATERIAL AND CONSTRUCTION SPECIFICATIONS SHALL BE APPROVED AND DONE IN ACCORDANCE WITH THE TOWN OF WAREHAM FIRE DISTRICTS RULES AND REGULATIONS.
 - RETAINER GLANDS SHALL BE USED AT ALL JOINTS (ANCHOR TEE, GATE VALVES, HYDRANT AND ALL FITTINGS). RETAINER GLANDS SHALL BE OF THE LOCKING GLAND-TYPE, MEGALUG, AS MANUFACTURED BY EBBA IRON.

CONCRETE THRUST BLOCK
N.T.S.

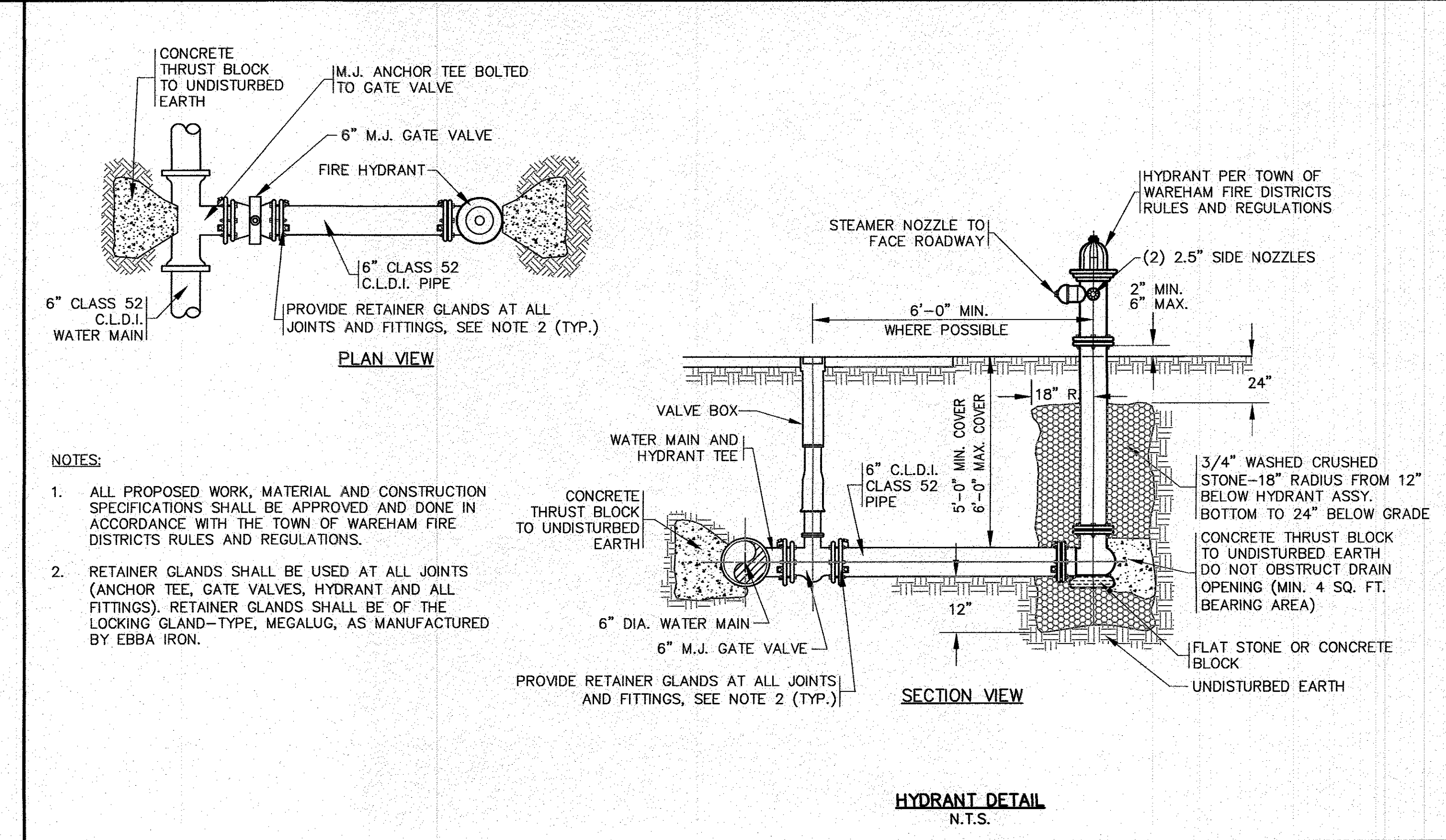

- NOTES:**
- ALL PROPOSED WORK, MATERIAL AND CONSTRUCTION SPECIFICATIONS SHALL BE APPROVED AND DONE IN ACCORDANCE WITH THE TOWN OF WAREHAM FIRE DISTRICTS RULES AND REGULATIONS.
 - RETAINER GLANDS SHALL BE USED AT ALL JOINTS (ANCHOR TEE, GATE VALVES, HYDRANT AND ALL FITTINGS). RETAINER GLANDS SHALL BE OF THE LOCKING GLAND-TYPE, MEGALUG, AS MANUFACTURED BY EBBA IRON.

HYDRANT DETAIL
N.T.S.

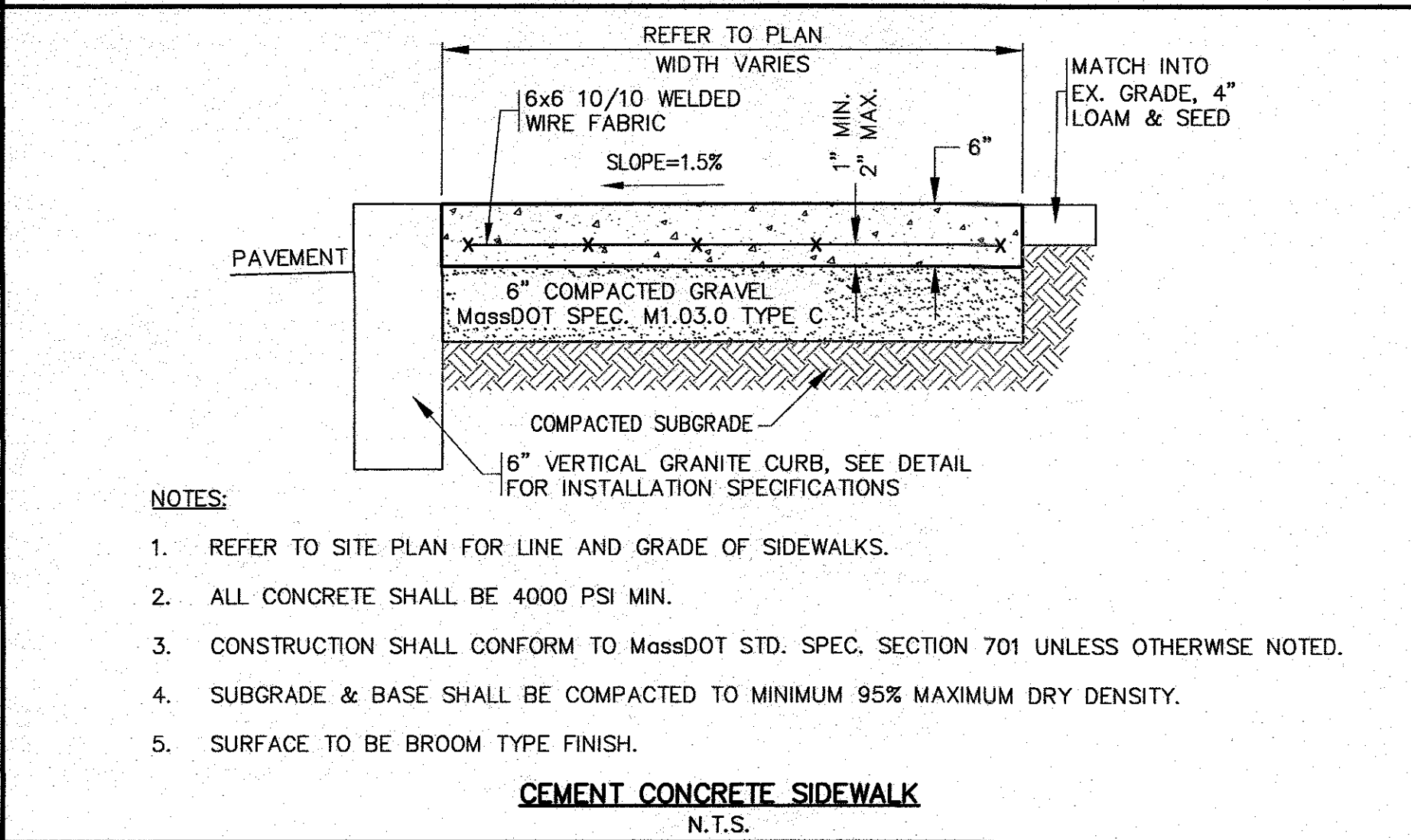

- NOTES:**
- REFER TO SITE PLAN FOR LINE AND GRADE OF SIDEWALKS.
 - ALL CONCRETE SHALL BE 4000 PSI MIN.
 - CONSTRUCTION SHALL CONFORM TO MassDOT STD. SPEC. SECTION 701 UNLESS OTHERWISE NOTED.
 - SUBGRADE & BASE SHALL BE COMPACTED TO MINIMUM 95% MAXIMUM DRY DENSITY.
 - SURFACE TO BE BROOM TYPE FINISH.

CEMENT CONCRETE SIDEWALK
N.T.S.

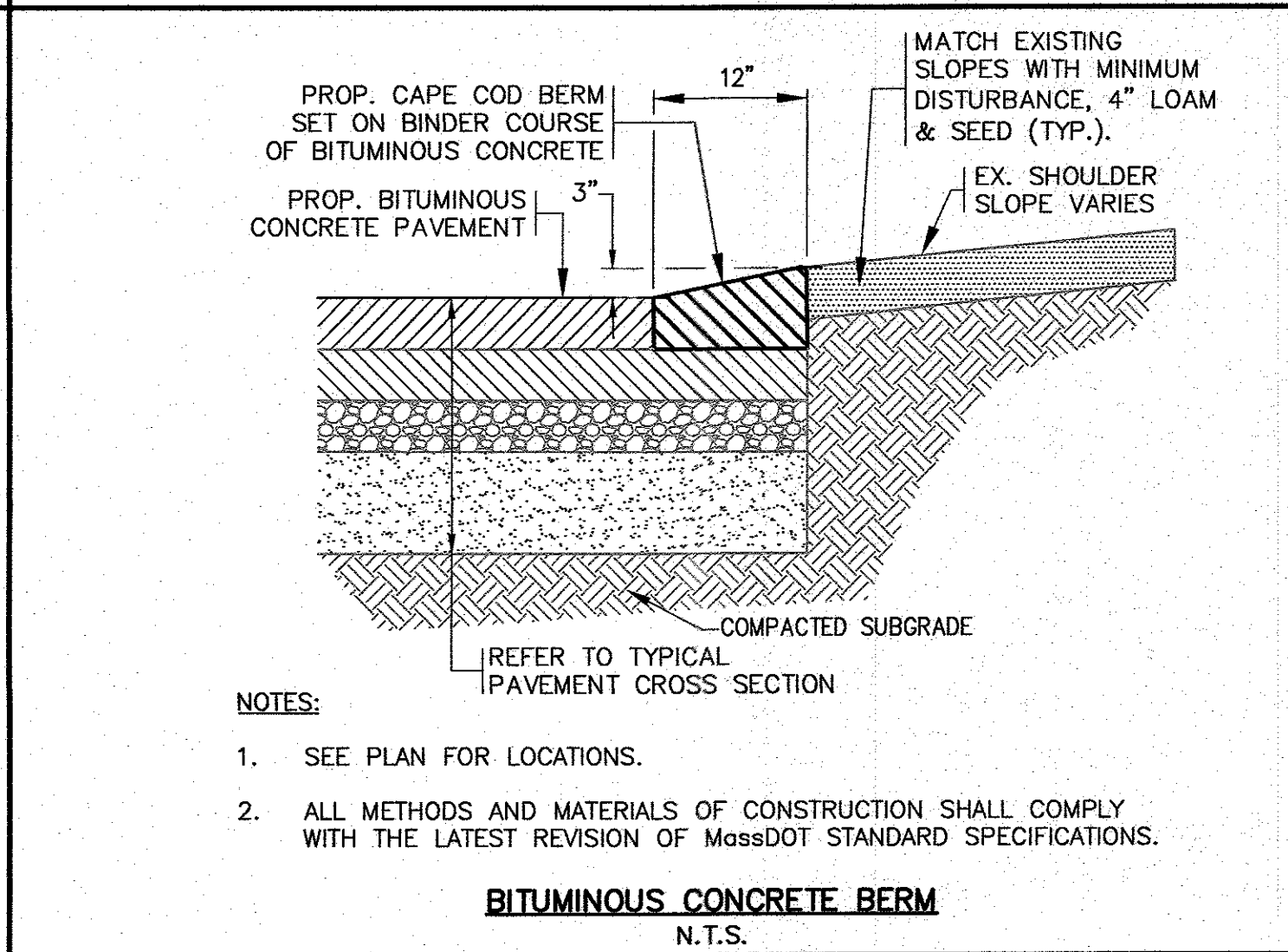

- NOTES:**
- SEE PLAN FOR LOCATIONS.
 - ALL METHODS AND MATERIALS OF CONSTRUCTION SHALL COMPLY WITH THE LATEST REVISION OF MassDOT STANDARD SPECIFICATIONS.

BITUMINOUS CONCRETE BERM
N.T.S.

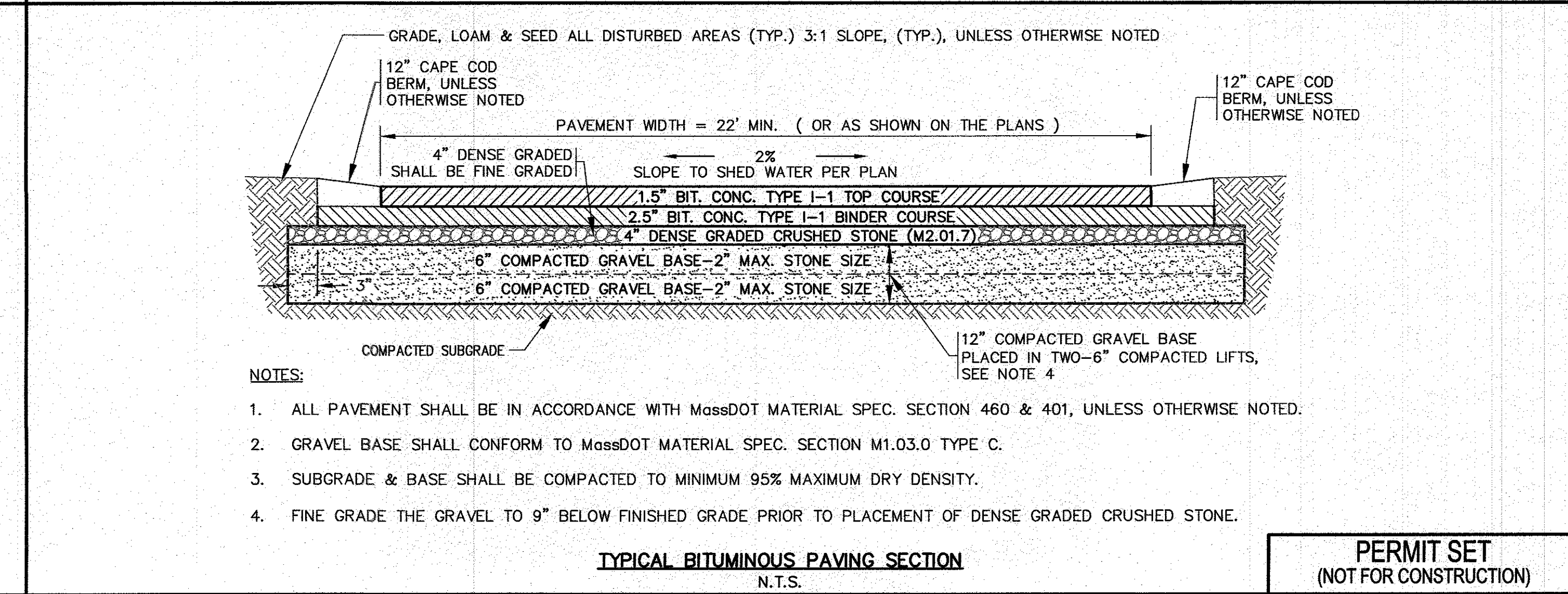

- NOTES:**
- ALL PAVEMENT SHALL BE IN ACCORDANCE WITH MassDOT MATERIAL SPEC. SECTION 460 & 401, UNLESS OTHERWISE NOTED.
 - GRAVEL BASE SHALL CONFORM TO MassDOT MATERIAL SPEC. SECTION M1.03.0 TYPE C.
 - SUBGRADE & BASE SHALL BE COMPACTED TO MINIMUM 95% MAXIMUM DRY DENSITY.
 - FINE GRADE THE GRAVEL TO 9" BELOW FINISHED GRADE PRIOR TO PLACEMENT OF DENSE GRADED CRUSHED STONE.

TYPICAL BITUMINOUS PAVING SECTION
N.T.S.

PERMIT SET
(NOT FOR CONSTRUCTION)

DATE: SEPT. 8, 2022	REV.	DATE	BY	APP'D	DESCRIPTION
DRAWN BY: JMP					
CHECKED BY: WFM					
JOB NO.: 21-9751					
SCALE: N.T.S.					

APPROVED BY:

G.A.F. ENGINEERING, INC.
PROFESSIONAL ENGINEERS & LAND SURVEYORS
268 MAIN STREET - WAREHAM, MA 02571
TEL: (508) 295-6600 FAX: (508) 295-6634
E-MAIL: info@gafeng.com

COPYRIGHT © 2022 G.A.F. ENGINEERING, INC. NO PART OF THIS DOCUMENT MAY BE REPRODUCED, STORED, OR TRANSMITTED IN ANY MANNER, ELECTRONIC OR MECHANICAL, WITHOUT THE EXPRESS WRITTEN CONSENT OF G.A.F. ENGINEERING, INC. WITH THE EXCEPTION OF ANY OFFICIAL BUSINESS INHERENT IN THE ASSOCIATION. ANY MODIFICATIONS MADE TO THIS DOCUMENT WITHOUT THE EXPRESS WRITTEN CONSENT OF G.A.F. ENGINEERING, INC. SHALL RENDER IT UNUSABLE.

SITE DEVELOPMENT PLAN
DETAIL SHEET 1

434 MAIN STREET WAREHAM, MA

PREPARED FOR:
NAZIH B. ELKALLASSI

20 TOWER TERRACE WAREHAM, MA

JOB NO.: 21-9751

DWG. 7 OF 9

