

TOWN OF WAREHAM ABUTTERS

MAP 103 LOTS A1, B1, C1, D1 + 1051

OWNER NSTAR ELECTIC COMPANY

MAP & LOT	OWNERS	STREET ADDRESS	TOWN & STATE	ZIP CODE
103-0-1006	CANTERBURY REALTY TRUST,	PO BOX 400,	W BRIDGEWATER, MA	02379
103-0-1007	KNUTE SUSAN TRUSTEE, C BOGS REALTY TRUST	436 WEST ST,	W BRIDGEWATER, MA	02739
103-0-1008	MONTEIRO ROBERT D,	910 COUNTY RD,	W WAREHAM, MA	02576
103-0-1012	TREMONT ENTERPRISE CORP,	PO BOX 7	W WAREHAM, MA	02576
103-0-1015, A	CRANCARP LIMITED PARTNERSHIP,	165 COUNTY RD,	PLYMPTON, MA	02367
103-0-1016, A	STRINGER GRANVILLE E, STRINGER JUDITH S	11 DOTY ST,	W WAREHAM, MA	02576
103-0-1023	HATCH BENJAMIN W III, HATCH TAMSEN A	8 DOTY ST,	W WAREHAM, MA	02576
103-0-1027	NSTAR ELECTRIC COMPANY, PROPERTY TAX DEPT	PO BOX 2915,	HARTFORD, CT	06104
103-0-1032	RINTA ANDREW B, RINTA JENNIFER L	45 N CARVER RD,	W WAREHAM, MA	02576
103-0-1054	ROQUE ADRIANA	12 DOTY ST,	W WAREHAM, MA	02576
103-0-A1	NSTAR ELECTRIC COMPANY, DBA EVERSOURCE ENERGY	247 STATION DR	WESTWOOD, MA	02090
103-0-B1	NSTAR ELECTRIC COMPANY, DBA EVERSOURCE ENERGY	247 STATION DR	WESTWOOD, MA	02090
103-0-H6	PAGAN-RAMOS JORGE, BUIL-LAGUNA WALMA A	C/O HABITAT FOR HUMANITY, 1A BYRNE CIR	W WAREHAM, MA	02576
103-0-H6	GRONBLOM STEVEN R & TAMMIE L, C/O HABITAT FOR HUMANITY	1B BYRNE CIR	W WAREHAM, MA	02576
103-0-H6	ADAMS JEANNE	3A BYRNE CIR	W WAREHAM, MA	02576
103-0-H6	REDD JOSLYN D, C/O HABITAT FOR HUMANITY	3B BYRNE CIR	W WAREHAM, MA	02576

CERTIFIED ABUTTERS AS THEY APPEAR
ON OUR TAX ROLLS AS OF 3/20/2024

Chris Vandenberghe

ASSESSORS OFFICE

REQUESTED BY

CHRIS VANDENBERGHE

774 501-2176

CVANDENBERGHE@CECINC.COM

ArcGIS Web Map

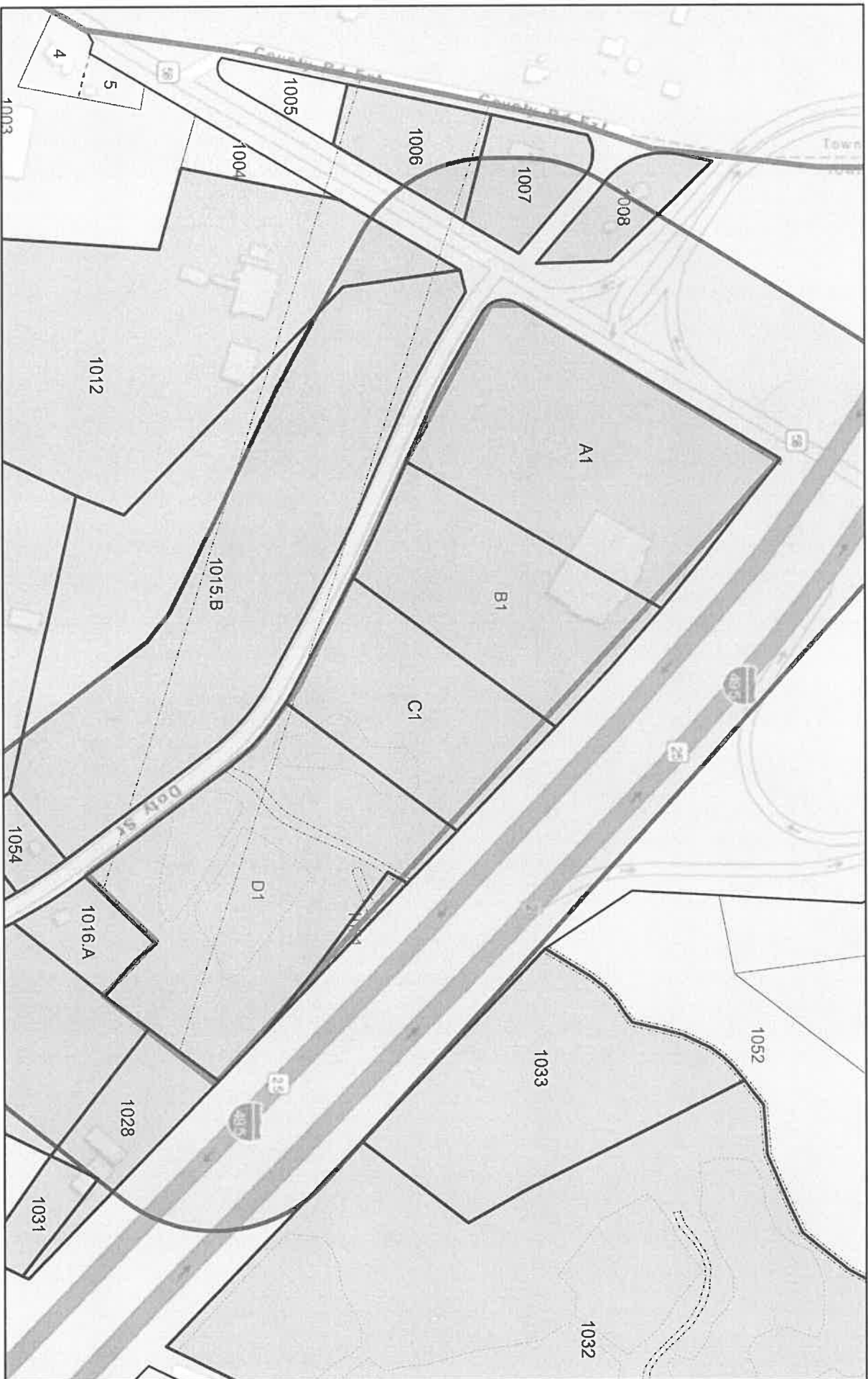

3/20/2024, 3:49:52 PM

- Parcels with CAMA Data
- Town Line
- Parcel Lines
- Common Line
- Property Line
- Public Road
- MiscPolys
- Private Road ROW
- Right of Way
- Utility
- Miscellaneous Lines
- Wetland

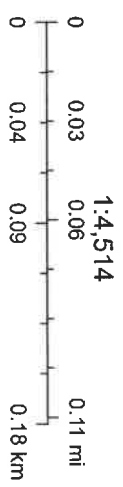

CURRENT OWNER	TOPO	UTILITIES	STRT / ROAD	LOCATION	DESCRIPTION	Code	Appraised	Assessed									
NSTAR ELECTRIC COMPANY					COMMERC.	3620	2,039,200	2,039,200									
DBA EVERSOURCE ENERGY					COM LAND	3620	559,200	559,200									
247 STATION DR					COMMERC.	3620	184,100	184,100									
WESTWOOD MA 02090																	
AT Pctd ID Total Ac 18.99 District 10 S.C.E. GIS ID M_260827_839551		Plan # Assoc. Parcels B1,C1 D1+1051		VISION													
Assoc Pctd#																	
RECORD OF OWNERSHIP		BK-VOL/PAGE		SALE DATE		Q/U		SALE PRICE		VC							
NSTAR ELECTRIC COMPANY	56129	190	12-07-2021	U	1	5,200,000	10	2024	3620	2,039,200	2023	3620	2,039,200	2022	3620	2,039,200	
STEAMSHIP ASSOCIATES LLC	23883	0348	01-07-2003	U	1	350,000	1P	3620	559,200	559,200	3620	559,200	3620	559,200	3620	559,200	
STEAMSHIP ASSOCIATES LLC	19466	0254	03-07-2001	U	V	184,100	1	3620	184,100	184,100	3620	184,100	3620	184,100	3620	184,100	
PARAMOUNT DEVELOPMENT	9696	0188	01-01-1901	U	U												
Total		2,782,500		2,782,500		2,782,500		2,782,500		2,782,500		2,782,500		2,782,500		2,782,500	

EXEMPTIONS		OTHER ASSESSMENTS	
Year	Code	Description	Amount
Total			0.00

ASSESSING NEIGHBORHOOD		NOTES	
Nbhd	Nbhd Name	Tracing	Batch
3000	B		

BUILDING PERMIT RECORD		LAND LINE VALUATION SECTION	
Permit ID	Issue Date	Type	Description
B23-701	01-29-2024	AL	Alterations
B22-757	12-12-2022	MS	Misc.
B22-660	11-18-2022	DE	Demolish
C18-045	08-24-2017	AL	Alterations
06089	07-29-2005	SN	Sign
06088	07-29-2005	SN	Sign
03984	05-29-2003	SN	Sign

Amount	Insp Date	% Comp	Date Comp	Comments
8,739,000		0		CINEMA TO TRAINING CENT
44,000		100		FIRE SPRINKLER SYSTEM
250,000	03-23-2023	100		DEMO CINEMA INTERIOR
300,000	01-20-2018	100		REPL THEATER SEATS
2,200	07-01-2009	100		1X2 CINEMA SIGN
1,500	07-01-2009	100		1X1 SIGN
10,000	07-01-2003	100		

VISIT / CHANGE HISTORY		APPRaised VALUE SUMMARY	
Date	Id	Type	Is
03-23-2023	SC		
08-27-2019	BL		
01-24-2018	SC		
08-12-2009	RG		
07-01-2003	PD		

#	Use Cod	Description	Zone	D	Front	Depth	Land Units	Unit Price	I. Factor	S.A.	Acres	CFact	St.Ixd	Adj.	Notes	Special Pricing	S. AdjF	Adj Unit	Land Value		
1	3620	MOVIE THTR	SC	1	0	0	4,000	166,300.0	1.00000	C	1.000	1.00	3000	0.70	SITE	0	1.0000		471,200		
1	3620	MOVIE THTR	SC	1	0	0	10,000	16,000.00	1.00000	C	1.000	0.50		1.00	EXCS-TOP0	0	1.0000		80,000		
1	3620	MOVIE THTR	SC	1	0	0	5,000	16,000.00	1.00000	C	1.000	0.10		1.00	MARSH	0	1.0000		8,000		
Total Card Land Units							19.00	AC	Parcel Total Land Area							19.00	Total Land Value				559,200