



Tobey Hospital

43 High Street, Wareham, MA 02571



 Pylon Sign
Print# 4396JK-3

 Building Sign
Print# 4398JK-10
Print#1165JK-5

 Directional Sign
Print# 1096JK-2

TOBEY HOSPITAL

Print# 1472JK

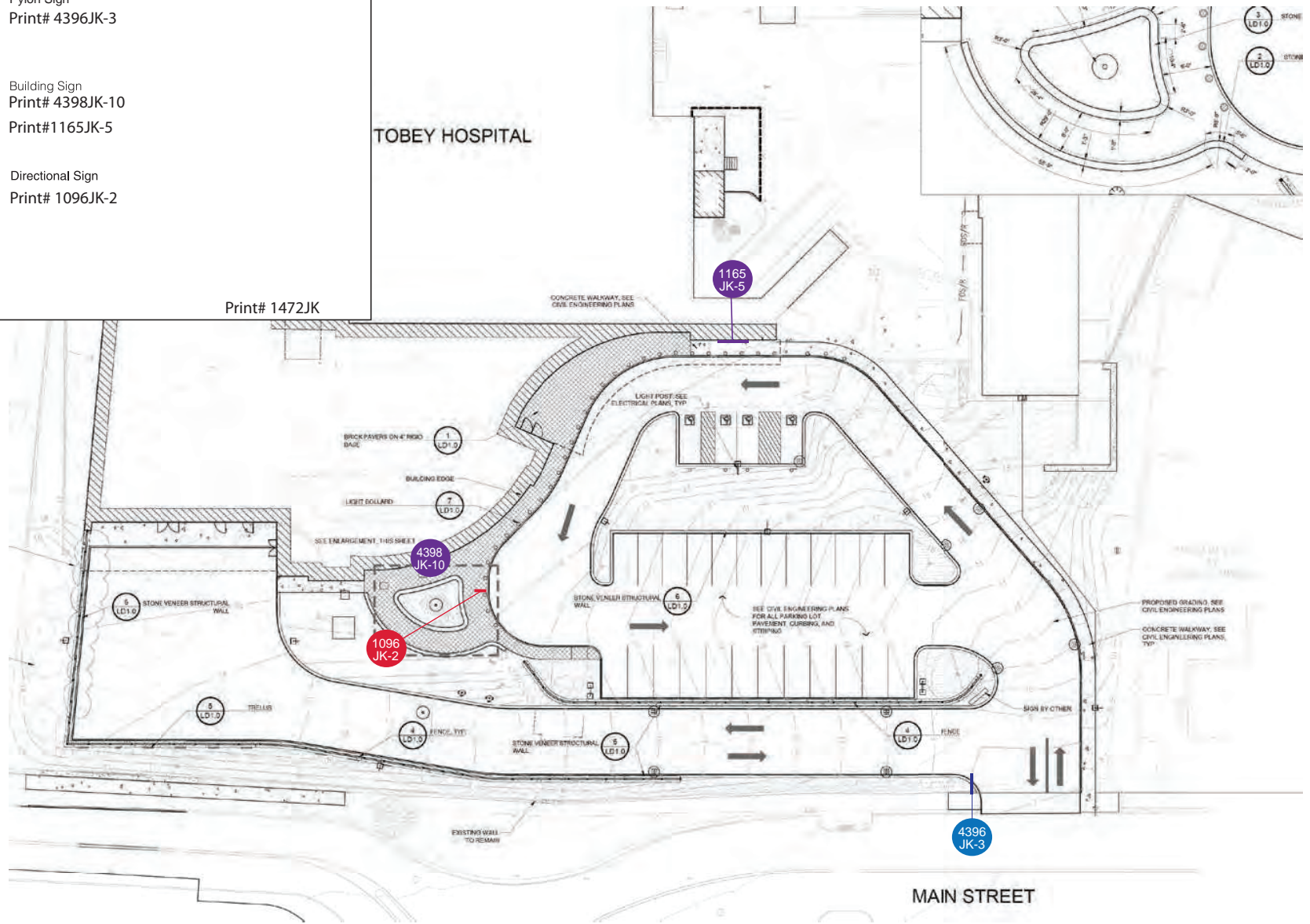

(A) Sign Location Plan
Not to Scale

Print 9404JK-5	Date 10/18/21	OQ# 40841	Line	Line#	SP	MGL	Sign Type	Various
CLIENT APPROVAL		Title	Southcoast Healthcare				Location	101 Page Street
		City/State	New Bedford, MA					New Bedford MA 02740
AUTHORIZED SIGNATURE		Customer	Southcoast Healthcare				Description	Site Plan
		DATE	Int. Note					

LAURETANO
SIGN GROUP

1 Tremco Drive. Terryville, CT 06786
phone: 860.582.0233 fax: 860.583.0949
signs@lauretano.com www.lauretano.com



Signage Placement

Print 4398JK-10	Date 10/18/21	ES# 40841	Line 5	SP ML	Sign Type 17714.12A-R2-Custom
CLIENT APPROVAL		Title Southcoast Health Care	Location As Illustrated		
		City/State Wareham, MA	Size Refer to Diagram (104.59 sq. ft. Total)		
AUTHORIZED SIGNATURE _____ DATE _____		Customer Southcoast Health Care	Description Trimless Channel Letter		
		Int. Note			

LAURETANO
SIGN GROUP

1 Tremco Drive. Terryville, CT 06786
 phone: 860.582.0233 fax: 860.583.0949
 signs@lauretano.com www.lauretano.com



Scale: 3/16" = 1'

Front View

Southcoast Health: 2' 2" x 25' 9" = 55.79

Tobey Hospital: 2' 7.8" x 18' 5" = 48.80

COLORS / MATERIALS

Trimless Channel Letters (Steelart Edgelit 102 or Equivalent):

Logo Face: White Acrylic with 1st Surface Applied 3M 3630-236 Teal Trans. PSV.

Letter Faces: White Acrylic with 1st Surface Applied 3M 3650-114 with Digitally Printed Gray to Match PMS 425c. (Gray Day/White Night)

Returns: 3" Deep Brushed Aluminum Painted PMS 425C (Satin Finish)

Backs: .063" Thk. Aluminum Backs.

Illumination: 6500K "White Prism" Sloan LED Illumination

Registered Mark: 1/2" White Acrylic with 1st Surface Applied 3M 3650-114 with Digitally Printed Gray to Match PMS 425c.

NOTES

Primary Electrical By Others.

Volt: 120 - Power is based off 120 volt.
 If signs use anything other than 120 volt,
 then a difference in price will apply or a step
 down transformer will need to be used.

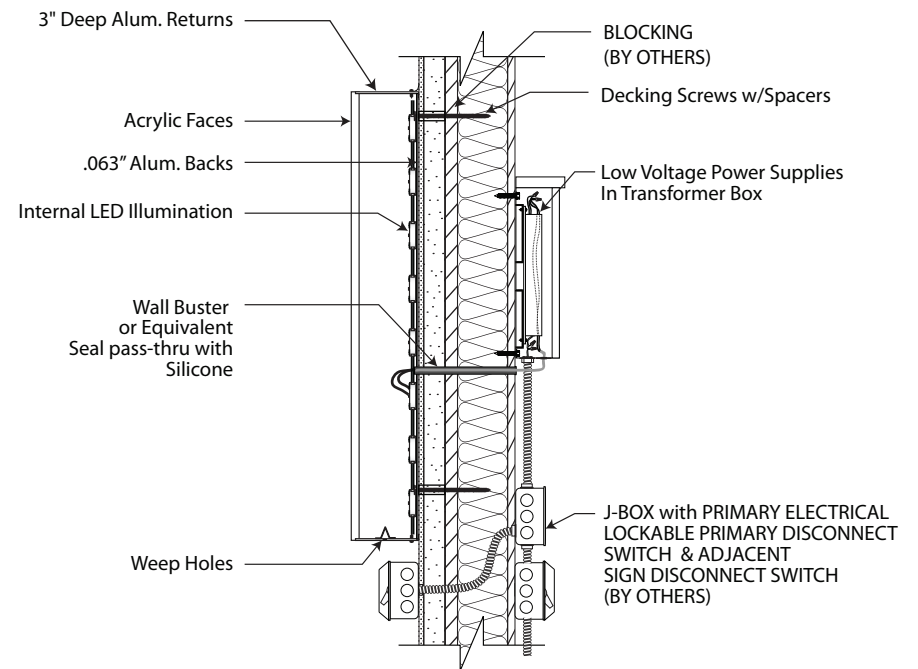

Typical Channel Letter Mounting (NTS)

PROCEED TO PRODUCTION	Print 4398JK-10	Date 10/18/21	Installation Method
	ES# 40841	Line 5	Decking Screws w/Silicone
AUTHORIZED SIGNATURE _____	= Critical Dimension for Internal Quality Control	UL FILE NO. E70436	Amperage _____ Volts _____
DATE _____			
2 of 2	<small>This drawing contains original elements created by Lauretano Sign Group, Inc., is property of Lauretano Sign Group, Inc. and is subject to all applicable copyright laws. This drawing may not be used in any way until full payment is received by Lauretano Sign Group, Inc. It is intended for review and approval purposes only, and is not to be reproduced, copied, transmitted by electronic media, or exhibited in any fashion to anyone outside your organization without the expressed written consent of Lauretano Sign Group, Inc.</small>		 <small>1 Tremco Drive, Terryville, CT 06786 • Phone: 860.582.0233 signs@lauretano.com www.lauretano.com</small>



Print 1165JK-5	Date 10/18/21	OQ# 40841	Line 21	SP MGL	Sign Type	Plate Letters
CLIENT APPROVAL		Title	Southcoast Health		Location	As Illustrated
		City/State	Wareham, MA		Size	6' 2.4" x 7' 0" (31.2 sqft)
AUTHORIZED SIGNATURE		Customer	Southcoast Health		Description	1/4" Thk. Alum. Plate Letters
		DATE	Int. Note			

LAURETANO
SIGN GROUP

1 Tremco Drive. Terryville, CT 06786
 phone: 860.582.0233 fax: 860.583.0949
 signs@lauretano.com www.lauretano.com



Scale: 1/2" = 1'

COLORS / MATERIALS

Trimless Channel Letters (Steelart Edgelit 102 or Equivalent):

Letter Faces: White Acrylic with 1st Surface Applied 3M 3650-114 with Digitally Printed Gray to Match PMS 425c. (Gray Day/White Night)
 Returns: 3" Deep Brushed Aluminum Painted PMS 425C (Satin Finish)
 Backs: .063" Thk. Aluminum Backs.
 Illumination: 6500K "White Prism" Sloan LED Illumination

NOTES

Primary Electrical By Others.

Volt: 120 - Power is based off 120 volt.
 If signs use anything other than 120 volt,
 then a difference in price will apply or a step
 down transformer will need to be used.

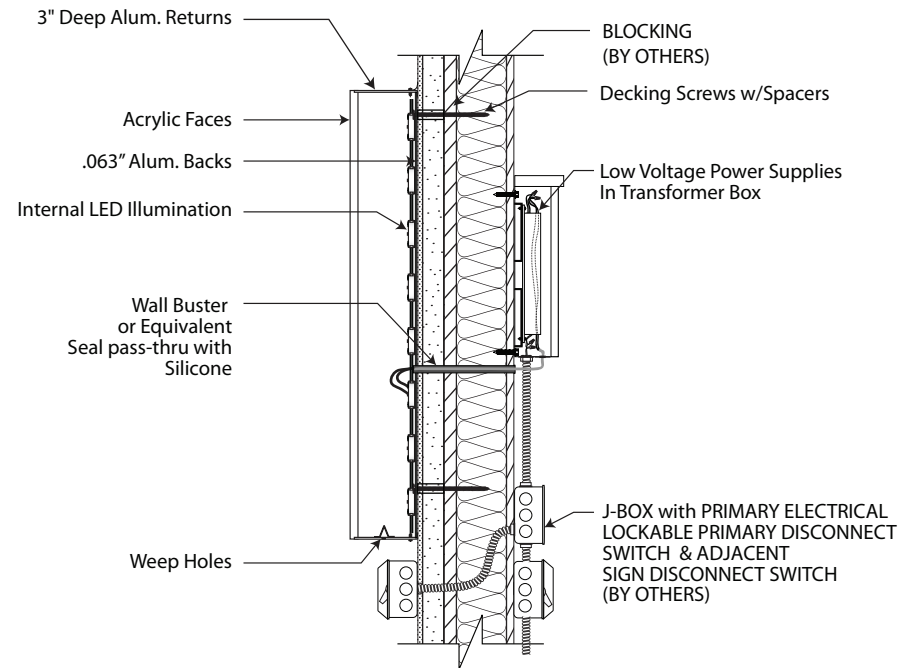

Typical Channel Letter Mounting (NTS)

PROCEED TO PRODUCTION	Print 1165JK-5	Date 10/18/21	Installation Method
	ES# 40841	Line 21	Stud & Silicone Mount
AUTHORIZED SIGNATURE _____	= Critical Dimension for Internal Quality Control	UL FILE NO. E70436	Amperage _____ Volts _____
DATE _____			



1 Tremco Drive., Terryville, CT 06786 • Phone: 860.582.0233
 signs@lauretano.com www.lauretano.com

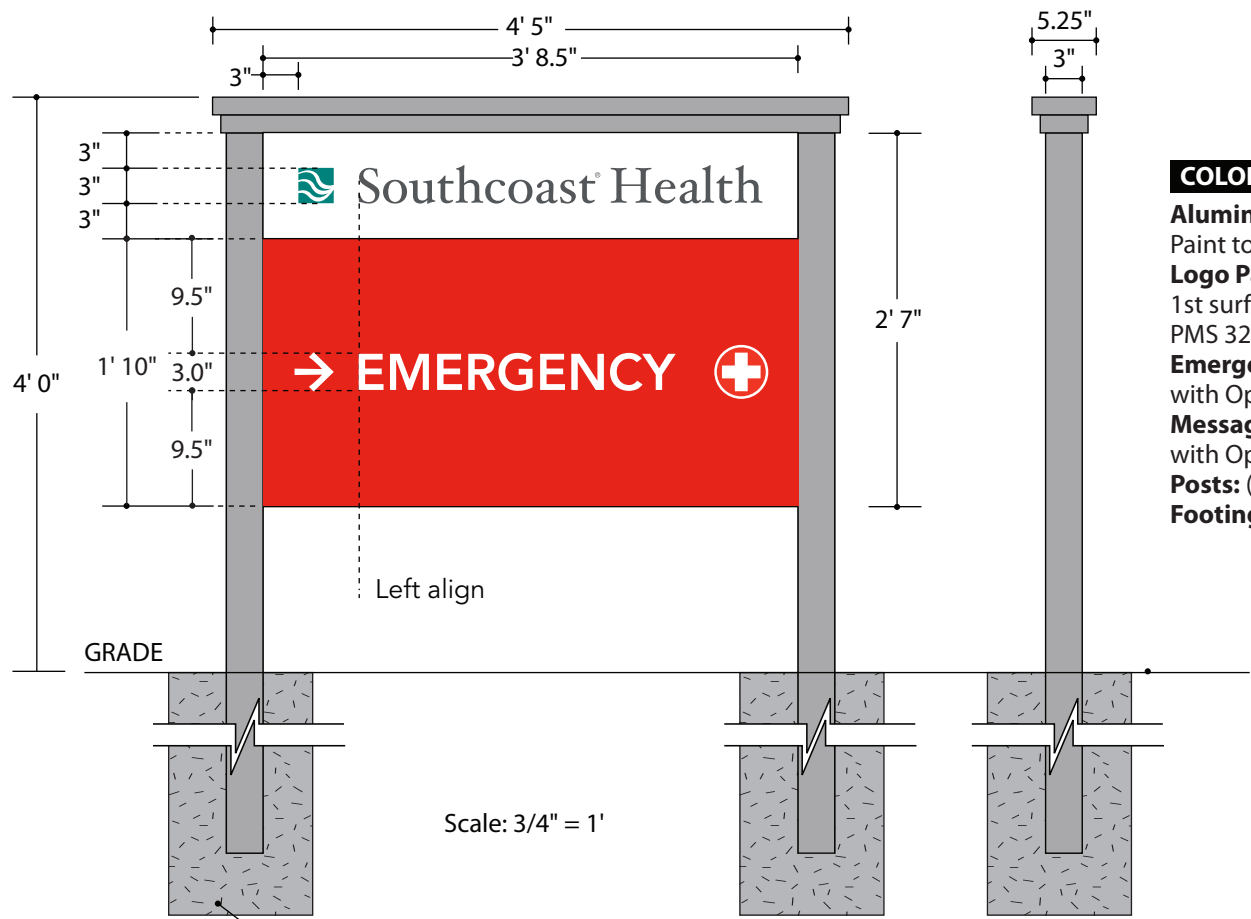

COLORS / MATERIALS

- Aluminum Cap:** Cornice to be Built from 0.125" Thk. Aluminum Tube, Paint to Match PMS Cool Gray 6c.
- Logo Panel & Logo:** 0.125" Thk Aluminum Panel Painted White with 1st surface applied HP PSV digitally printed PSV to Match PMS 3282c Turquoise & PMS 425c Gray.
- Emergency Panel:** Aluminum Panel Painted to Match Red PMS 485 C with Opaque White 3M Vinyl 180C-10 (White) Applied 1st Surface.
- Message Panel:** Aluminum Panel Painted to Match Gray PMS 425 C with Opaque White 3M Vinyl 180C-10 (White) Applied 1st Surface.
- Posts:** (2) 3" x 3" Aluminum Post Paint to Match PMS Cool Gray 6c.
- Footing:** Direct Burial 1' 0" Dia. x 3' 6" Deep #3000 Concrete

Scale: 3/4" = 1'

Typical Direct Burial Foundation
1' 0" Dia. x 3' 6" Deep #3000 Concrete.

Print 1096JK-2	Date 8/30/21	OQ# 40841	Line 17	SP MGL	Sign Type	Directional Sign
CLIENT APPROVAL		Title	Southcoast Health		Location	As Illustrated
		City/State	Wareham, MA		Size	4' 0" x 4' 5" (17.66 sqft)
AUTHORIZED SIGNATURE _____ DATE _____		Customer	Southcoast Health		Description	Post and Panel Branded Directional Sign
		Int. Note				



1 Tremco Drive. Terryville, CT 06786
 phone: 860.582.0233 fax: 860.583.0949
 signs@lauretano.com www.lauretano.com

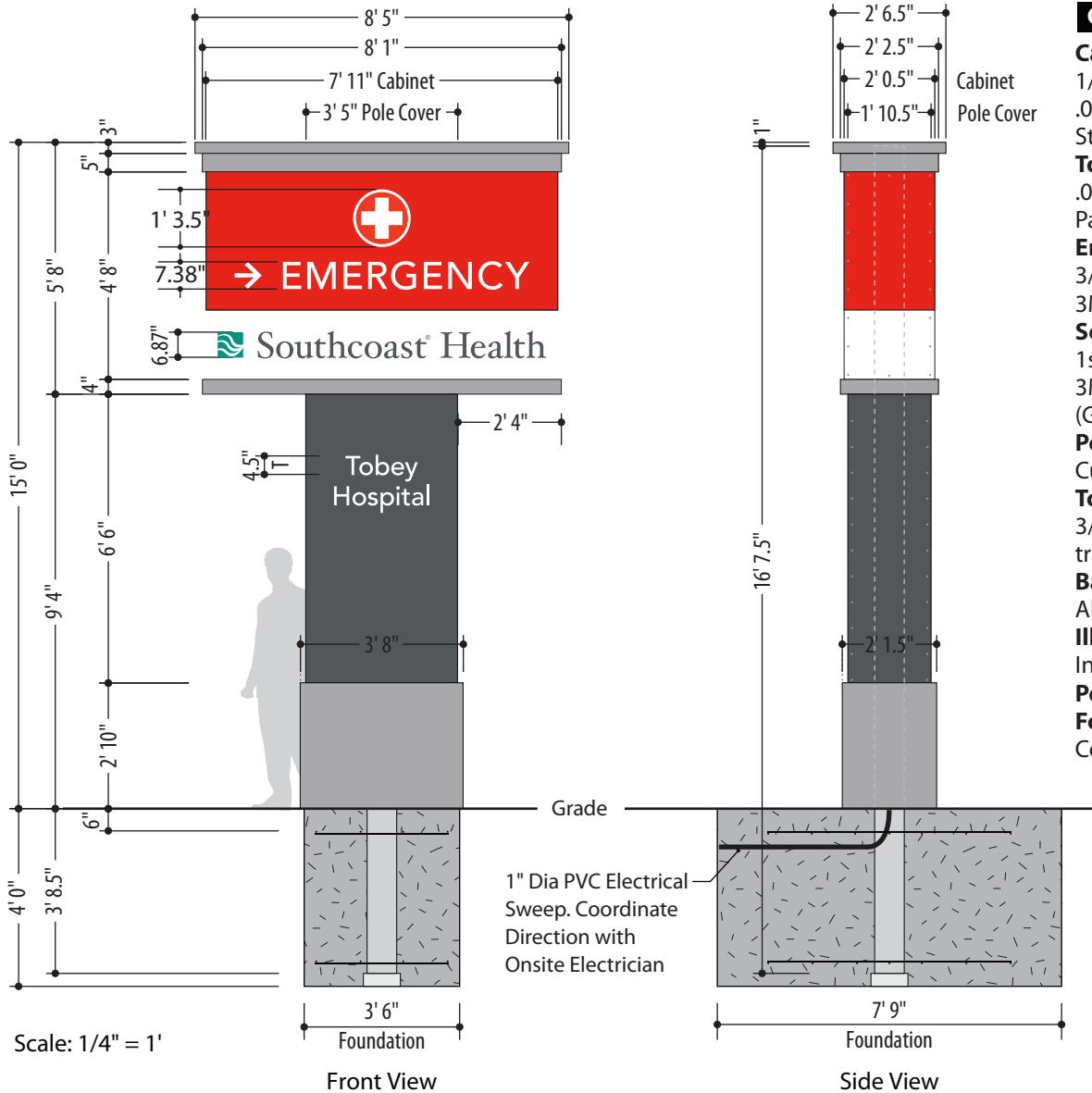

COLORS / MATERIALS

Cabinet: Fabricated 1.5" x 1.5" Alum. Angle Frame with 1/8" Thk. Cut-Thru Alum. Faces & .080" Thk. Alum. Removable Returns. Steel Angle for Pole Runners.

Top & Bottom Trim: 3" x 3", 5" x 2" & 4" x 4" Alum. Tube .080" Thk. Aluminum Cladding. Painted to match PMS Cool Gray 6c.

Emergency Band: Cut Thru Graphics backed up with 3/16" Thk. Clear Acrylic. Acrylic to receive 1st surface 3M 3630-20 trans. white PSV & 2nd surface 3M 3635-70 diffusion film.

Southcoast Health: Push-Thru 1/2" Clear Acrylic (1/4" Proud From Face) 1st surface applied 3M 3630-236 Teal Trans. PSV & 3M 3650-114 with Digitally Printed Gray to match PMS 425c. (Gray Day/White Night)

Pole Cladding: 1.5" x 1.5" Alum. Angle Frame with 1/8" Thk. Alum. Cut-Thru Face & .080" Thk. Alum. Returns. Paint to match PMS 425c Gray.

Tobey Hospital: Cut-Thru Graphics backed up with 3/16" Thk. Clear Acrylic. Acrylic to receive 1st surface 3M 3630-20 trans. white PSV & 2nd surface 3M 3635-70 diffusion film.

Base Cover: 1.5" x 1.5" Alum. Angle Frame with .063" Thk. Aluminum Cladding. Paint to match PMS Cool Gray 6c.

Illumination: Sloan LED "White Prism" 6500K. Inside upper cabinet and cladding behind "Tobey Hospital" Copy.

Poles: (1) 8" X 8" x 3/16" Thk. Square Steel Pole.

Footing: (1) 4'-0" Deep X 3'-6" Wide X 7'-9" #3000 Concrete Foundation with #4 Rebar 12" OC Top and Bottom.

Print 4396JK-3	Date 10/18/21	ES# 40841	Line 3	SP ML	Sign Type 17714.18B
CLIENT APPROVAL		Title Southcoast Health Care	Location As Illustrated		
		City/State Wareham, MA	Size 15' 0" x 8' 5" (126.25 sqft)		
AUTHORIZED SIGNATURE _____ DATE _____		Customer Southcoast Health Care	Description D/F Internally Illuminated Pylon Sign		
		Int. Note			

LAURETANO
SIGN GROUP

1 Tremco Drive. Terryville, CT 06786
phone: 860.582.0233 fax: 860.583.0949
signs@lauretano.com www.lauretano.com