

Phase II Landscape Plans prepared by Donald Leighton,
Registered Landscape Architect, MA #952

AUGUST 5, 2021



OVERVIEW PLAN OF PHASE II & PHASE III

TYPICAL LANDSCAPE PLANS FOR BOTH PHASE II & PHASE III

Planting layouts for 4 single family home sites.
(Plant schedule is duplicated from Phase I)



SINGLE FAMILY

PLANT SCHEDULE PLANTING PLAN 5

TREES	QTY	BOTANICAL NAME	COMMON NAME	SIZE	CONTAINER
AR	2	Acer rubrum	Red Maple	2.5"-3" Cal.	B&B
BN	1	Betula nigra	River Birch - Clump	2.5"-3" Cal.	B&B
CBF	3	Carpinus betulus 'Fastigiata'	Pyramidal European Hornbeam	2.5"-3" Cal.	B&B
CK	2	Cornus kousa	Kousa Dogwood	2"-2.5" Cal.	B&B
NSBT	1	Nyssa sylvatica 'Black Tupelo'	Sour Gum	2.5"-3" Cal.	B&B
PFVP	2	Pinus flexilis 'Vanderwolf's Pyramid'	Vanderwolf's Pyramid Pine	8' Ht.	B&B
QC	1	Quercus coccinea	Scarlet Oak	2.5"-3" Cal.	B&B
SC	2	Stewartia sinensis	Chinese Stewartia	2"-2.5" Cal.	B&B
SHRUBS	QTY	BOTANICAL NAME	COMMON NAME	SIZE	CONTAINER
CA	8	Clethra alnifolia	Summersweet Clethra	24"-30"	Cont.
HG	19	Hosta x 'Guacamole'	Plantain Lily	3 gal.	Cont.
HMES	7	Hydrangea macrophylla 'Endless Summer'	Endless Summer Hydrangea	#7	Cont.
ICS	4	Ilex crenata 'Steeds'	Steeds Japanese Holly	#7	Cont.
IGS	6	Ilex glabra 'Shamrock'	Inkberry	24"-30"	Cont.
JSBS	4	Juniperus scopulorum 'Blue Star'	Blue Star Juniper	#2	Cont.
RK	16	Rosa x 'Knockout'	Knockout Rose	#7	Cont.
SPDP	21	Spiraea japonica 'Double Play Pink'	Spirea 'Double Play Pink'	#3	Cont.
TONP	4	Thuja orientalis 'North Pole'	Oriental Arborvitae	#7	Cont.
VD	9	Viburnum dentatum 'Arrowwood'	Arrowwood Viburnum	24"-30"	Cont.
VH	5	Vaccinium corymbosum	Highbush Blueberry	24"-30"	Cont.
ANNUALS/PERENNIALS	QTY	BOTANICAL NAME	COMMON NAME	SIZE	CONTAINER
HHD	97	Hemerocallis x 'Happy Days'	Happy Days Daylily	1 gal.	Cont.
NFWL	70	Nepeta x faassenii 'Walkers Low'	Walkers Low Catmint	1 gal.	Cont.

PHASE II & PHASE III LANDSCAPE PLANS

Windward Pines II
at the Bay Pointe Club

TYPICAL LANDSCAPE PLANS FOR BOTH PHASE II & PHASE III

Planting layouts for 3 duplex home sites.
(Plant schedule is duplicated from Phase I)



DUPLEX

PLANT SCHEDULE PLANTING PLAN 1

TREES	QTY	BOTANICAL NAME	COMMON NAME	SIZE	CONTAINER
AR	3	<i>Acer rubrum</i>	Red Maple	2.5"-3" Cal.	B&B
BN	1	<i>Betula nigra</i>	River Birch - Clump	2.5"-3" Cal.	B&B
CBF	1	<i>Carpinus betulus</i> 'Fastigiata'	Pyramidal European Hornbeam	2.5"-3" Cal.	B&B
CK	1	<i>Cornus kousa</i>	Kousa Dogwood	2"-2.5" Cal.	B&B
NSBT	2	<i>Nyssa sylvatica</i> 'Black Tupelo'	Sour Gum	2.5"-3" Cal.	B&B
QC	3	<i>Quercus coccinea</i>	Scarlet Oak	2.5"-3" Cal.	B&B
SHRUBS	QTY	BOTANICAL NAME	COMMON NAME	SIZE	CONTAINER
HG	31	<i>Hosta x</i> 'Guacamole'	Plantain Lily	3 gal.	Cont.
HMES	18	<i>Hydrangea macrophylla</i> 'Endless Summer'	Endless Summer Hydrangea	#7	Cont.
ICS	11	<i>Ilex crenata</i> 'Steeds'	Steeds Japanese Holly	#7	Cont.
IGS	5	<i>Ilex glabra</i> 'Shamrock'	Inkberry	24"-30"	Cont.
IMCS	6	<i>Ilex x meserveae</i> 'Castle Spire'	Castle Spire Holly	#5	Cont.
IVRS	19	<i>Ilex verticillata</i> 'Red Sprite'	Red Sprite Winterberry	24"-30"	Cont.
JSBS	6	<i>Juniperus scopulorum</i> 'Blue Star'	Blue Star Juniper	#2	Cont.
RCC	3	<i>Rhododendron catawbiense</i> 'Chionoides'	Chionoides Rhododendron	#7	Cont.
RK	26	<i>Rosa x</i> 'Knockout'	Knockout Rose	#7	Cont.
SPDP	15	<i>Spiraea japonica</i> 'Double Play Pink'	Spirea 'Double Play Pink'	#3	Cont.
ANNUALS/PERENNIALS	QTY	BOTANICAL NAME	COMMON NAME	SIZE	CONTAINER
HHD	94	<i>Hemerocallis x</i> 'Happy Days'	Happy Days Daylily	1 gal.	Cont.
NFWL	37	<i>Nepeta x faassenii</i> 'Walkers Low'	Walkers Low Catmint	1 gal.	Cont.

PHASE II & PHASE III LANDSCAPE PLANS

Windward Pines II
at the Bay Pointe Club

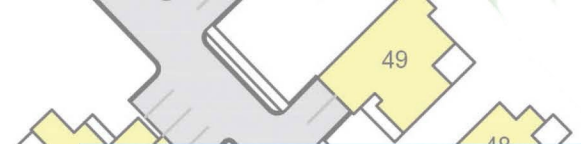

HERITAGE BIRCH

Birch will be used to 'frame' the duplexes.



Arborvitae will provide privacy from the road as well as an evergreen "edge" along the inner loop road

Split rail fencing will run along the inside of the sidewalk

INNER CIRCLE DUPLEXES

A combination of birch and arborvitae will be used in clusters as the primary tree planting for the inner circle. The upright branching pattern of the heritage birch allows it to be closer to the buildings than most deciduous trees.

The green giant arborvitae will provide solid privacy buffers and contrast well with the birch making it a unique setting within the Phase II Development.



GREEN GIANT ARBORVITAE



Starboard Drive will have a similar streetscape as Central Portion of Phase I.

PHASE II & PHASE III LANDSCAPE PLANS

Windward Pines II
at the Bay Pointe Club

PROPOSED BUFFER PLANTINGS

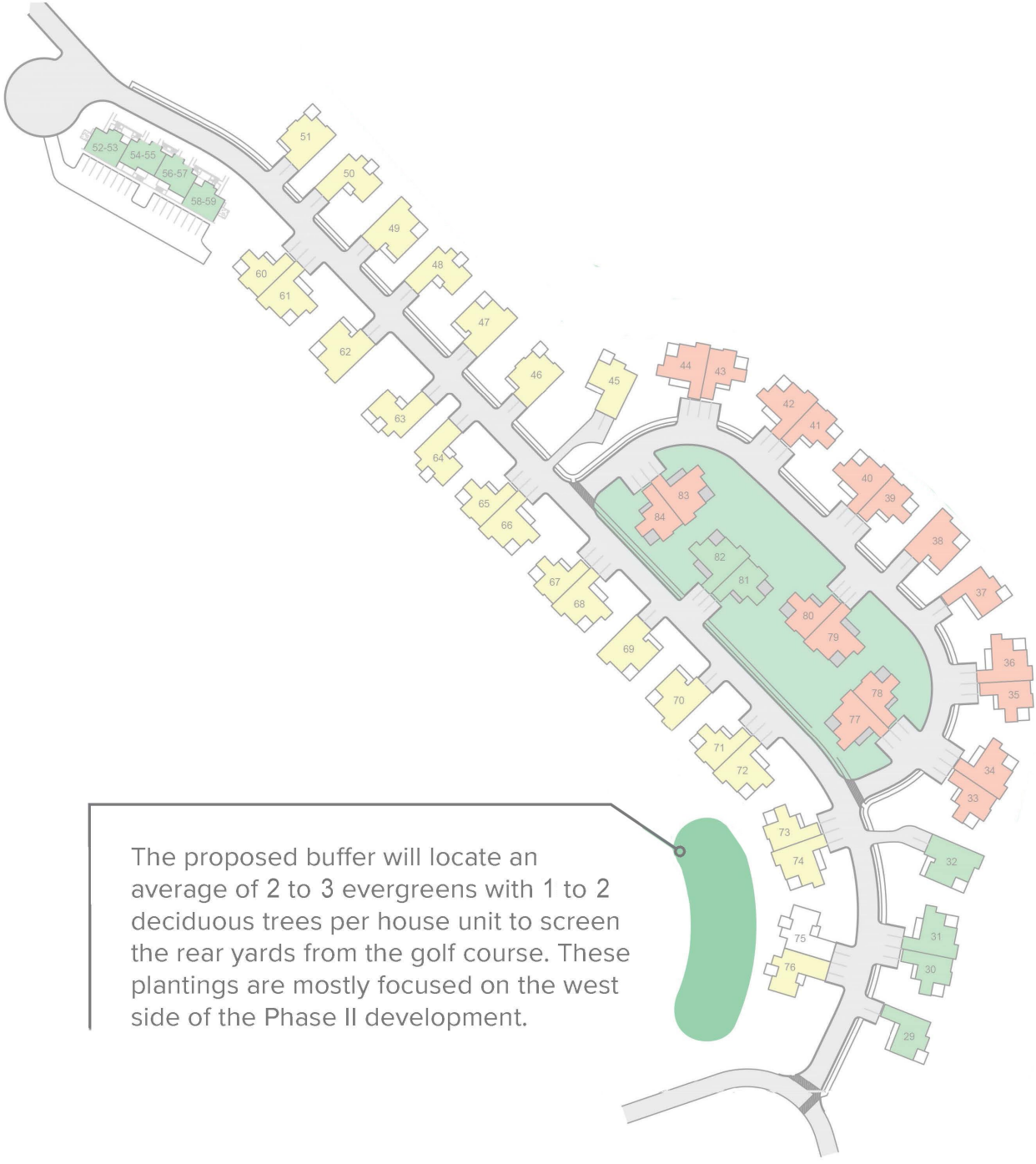

The proposed buffer will locate an average of 2 to 3 evergreens with 1 to 2 deciduous trees per house unit to screen the rear yards from the golf course. These plantings are mostly focused on the west side of the Phase II development.

EVERGREENS



WHITE PINE



CRYPTOMERIA JAPONICA

DECIDUOUS



PIN OAK



RED MAPLE



TREES/ROCKS

Existing tree buffer will remain between the 11th fairway and new homes, large boulders will create natural walls where needed.

The landscape work will utilize existing resources that are already stockpiled for use in planting, seeding, creating a retaining wall with boulders and mulching within existing and proposed woodland areas.



TOPSOIL

Topsoil will be screened and used for planting and establishing lawn areas.

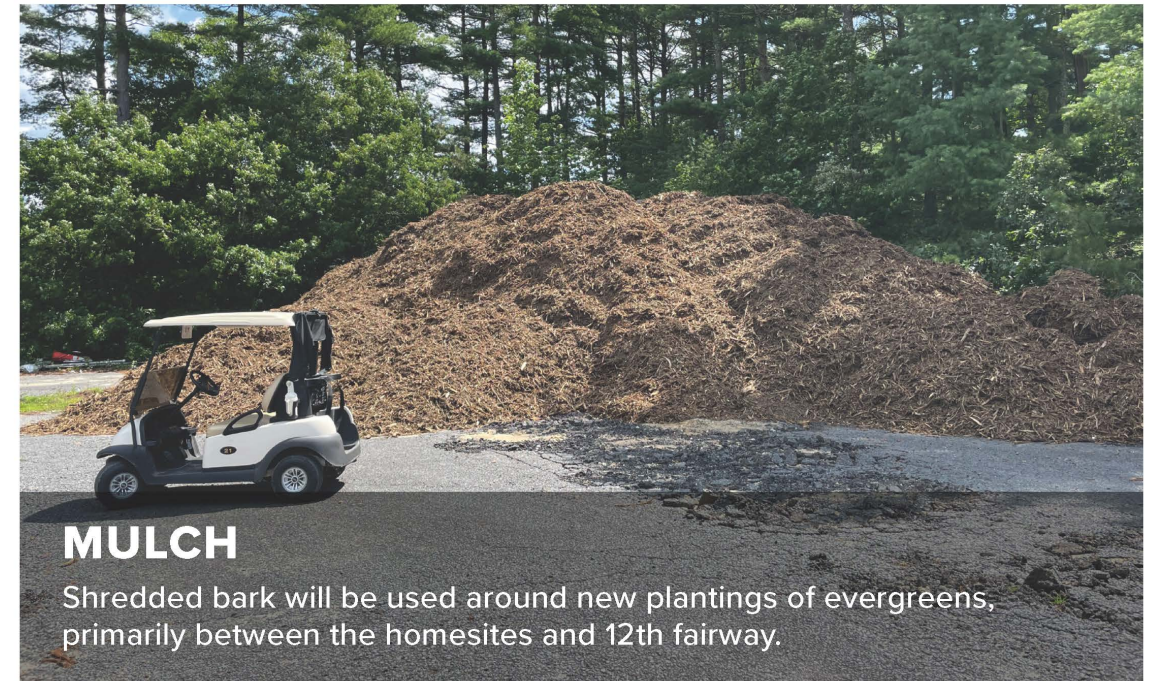

MULCH

Shredded bark will be used around new plantings of evergreens, primarily between the homesites and 12th fairway.



Split rail fence along sidewalk with deciduous canopy tree & understory plantings to provide a vegetated streetscape.



Typical front entry walk with low seasonal plantings.

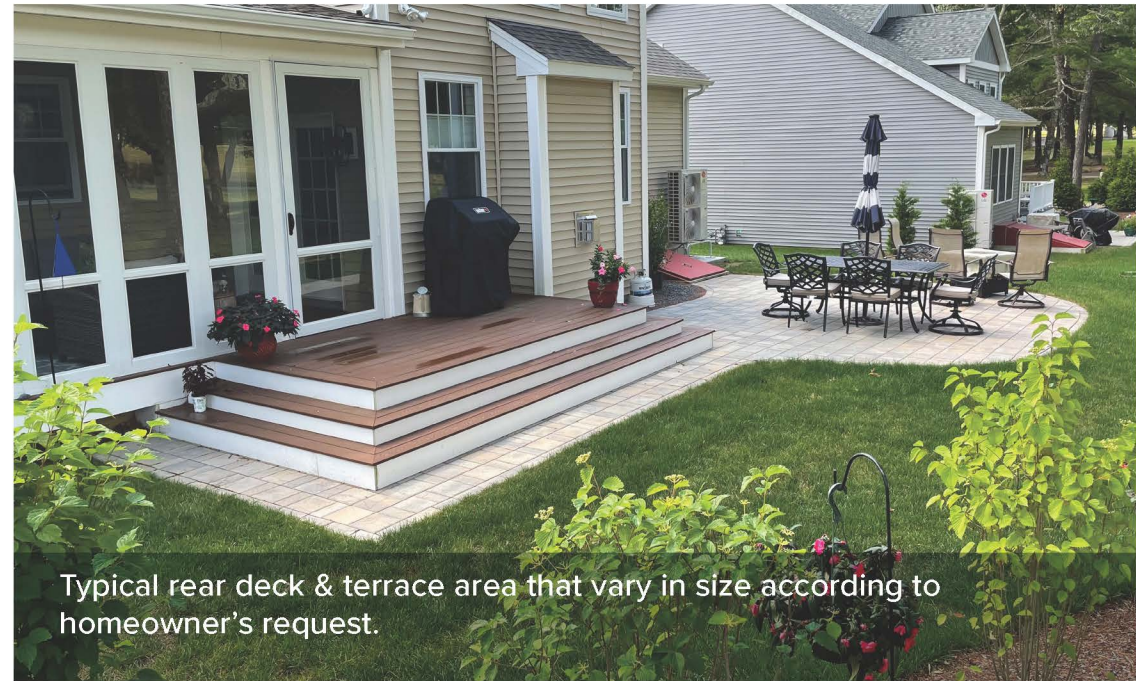

Typical rear deck & terrace area that vary in size according to homeowner's request.

EXISTING CONDITIONS FOR PHASE 1 LANDSCAPING



Mixed plantings of evergreens (Lawson Cypress Ilex) and flowering shrubs (Hydrangea, Viburnum) between 3-season rooms.



Heavy use of evergreens (Lawson Cypress) between deck areas.

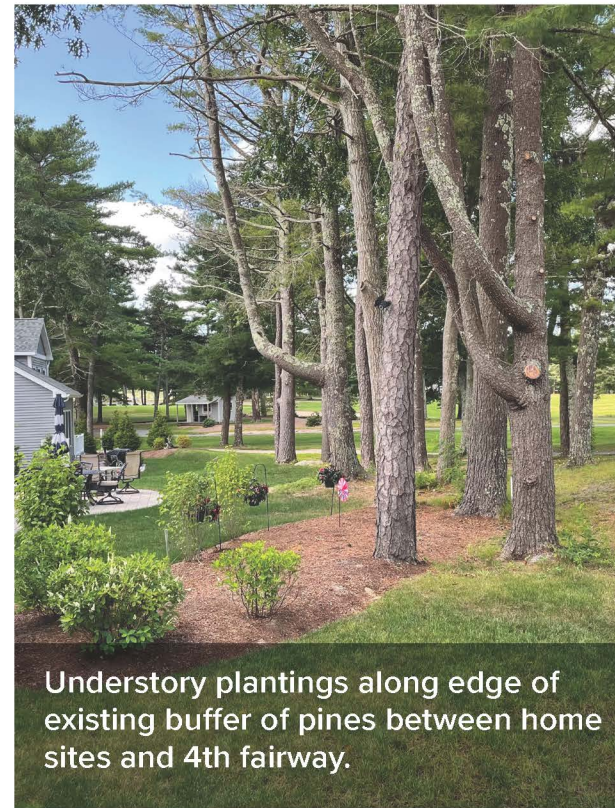

Understory plantings along edge of existing buffer of pines between home sites and 4th fairway.

EXISTING CONDITIONS FOR PHASE 1 LANDSCAPING